

SOLGUL

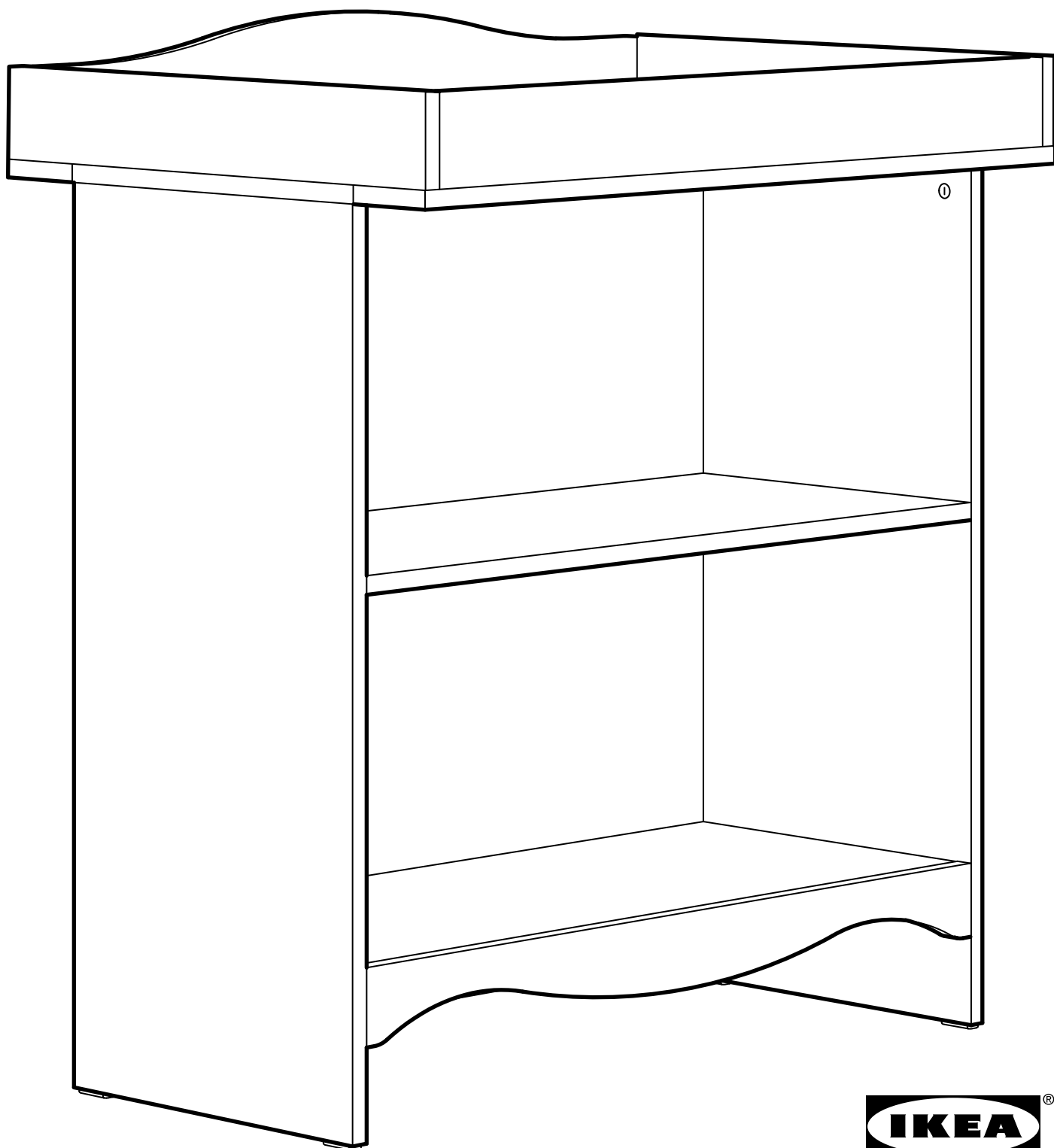

Design and Quality
IKEA of Sweden

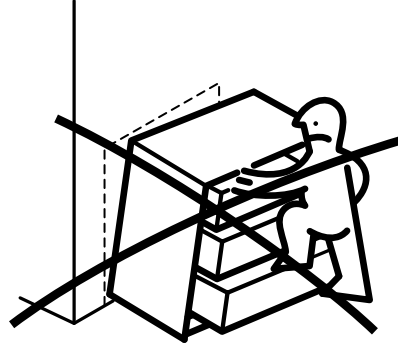
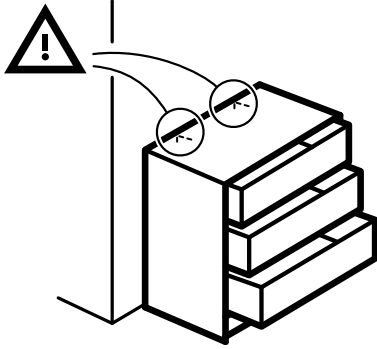

WARNING

Serious or fatal crushing injuries can occur from furniture tip-over. ALWAYS secure this furniture to the wall using tip-over restraints. To further reduce the risk of serious injury and death from tip-overs:

- Place heaviest items in the lower drawer.
- Do not set TVs or other heavy objects on top of this product.
- Never let children climb or hang on drawers, doors, or shelves.

ATTENTION

Risque de blessures graves ou mortelles en cas de basculement du meuble. TOUJOURS fixer ce meuble au mur à l'aide des fixations anti-basculement. Pour encore réduire les risques de blessures graves ou mortelles dus au basculement du meuble :

- Placer les objets les plus lourds dans le tiroir du bas.
- Ne pas poser de TV ou d'objet lourd sur le dessus de ce produit.
- Ne jamais laisser les enfants grimper ou s'accrocher aux tiroirs, portes ou tablettes.

ADVERTENCIA

Si el mueble vuelca, puede provocar lesiones muy graves e incluso mortales. Fija SIEMPRE este mueble a la pared utilizando los accesorios antivuelco. Para reducir aún más el riesgo de lesiones graves o incluso mortales causadas por el vuelco del mueble:

- Guarda los objetos más pesados en el cajón inferior.
- No pongas un TV u otros objetos pesados encima de este producto.
- Evita que los niños suban encima del mueble o se cuelguen de los cajones, las puertas o los estantes.

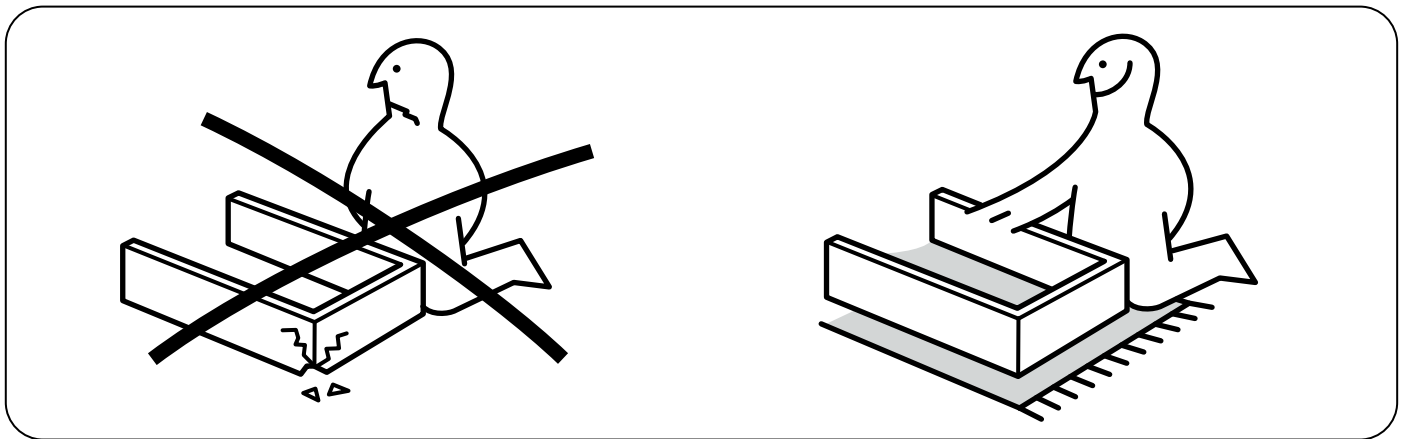
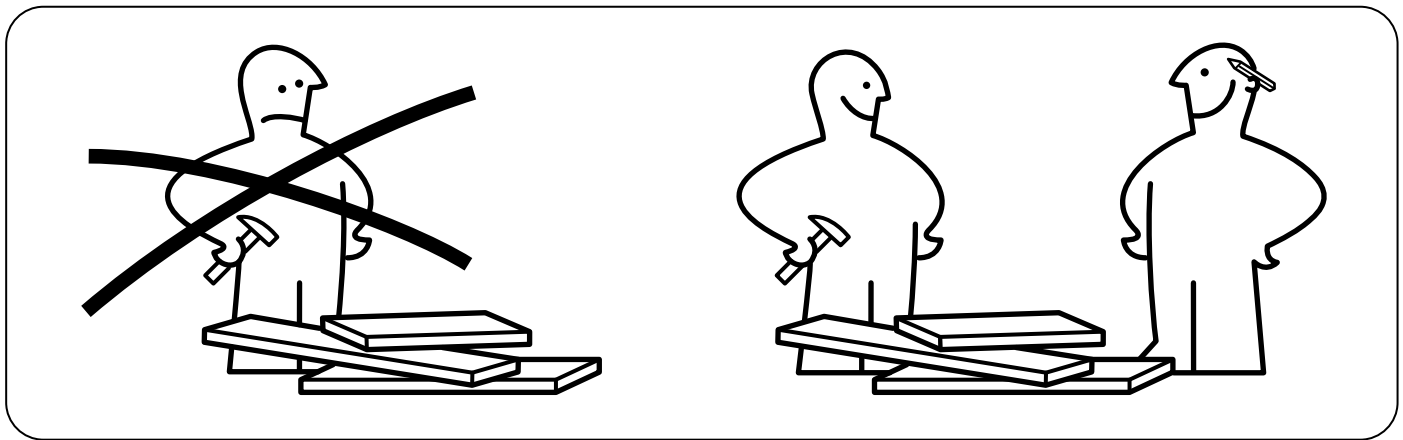
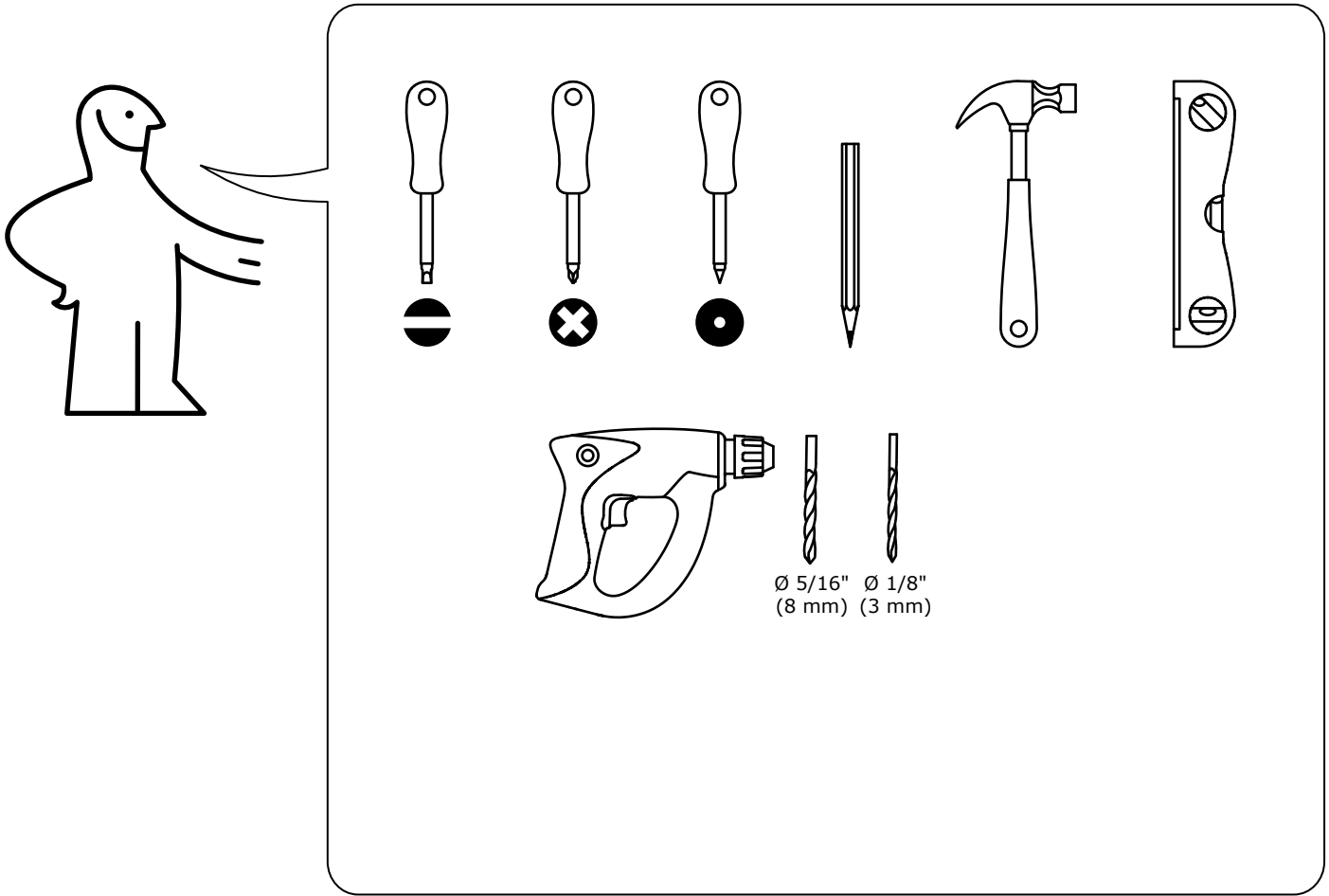

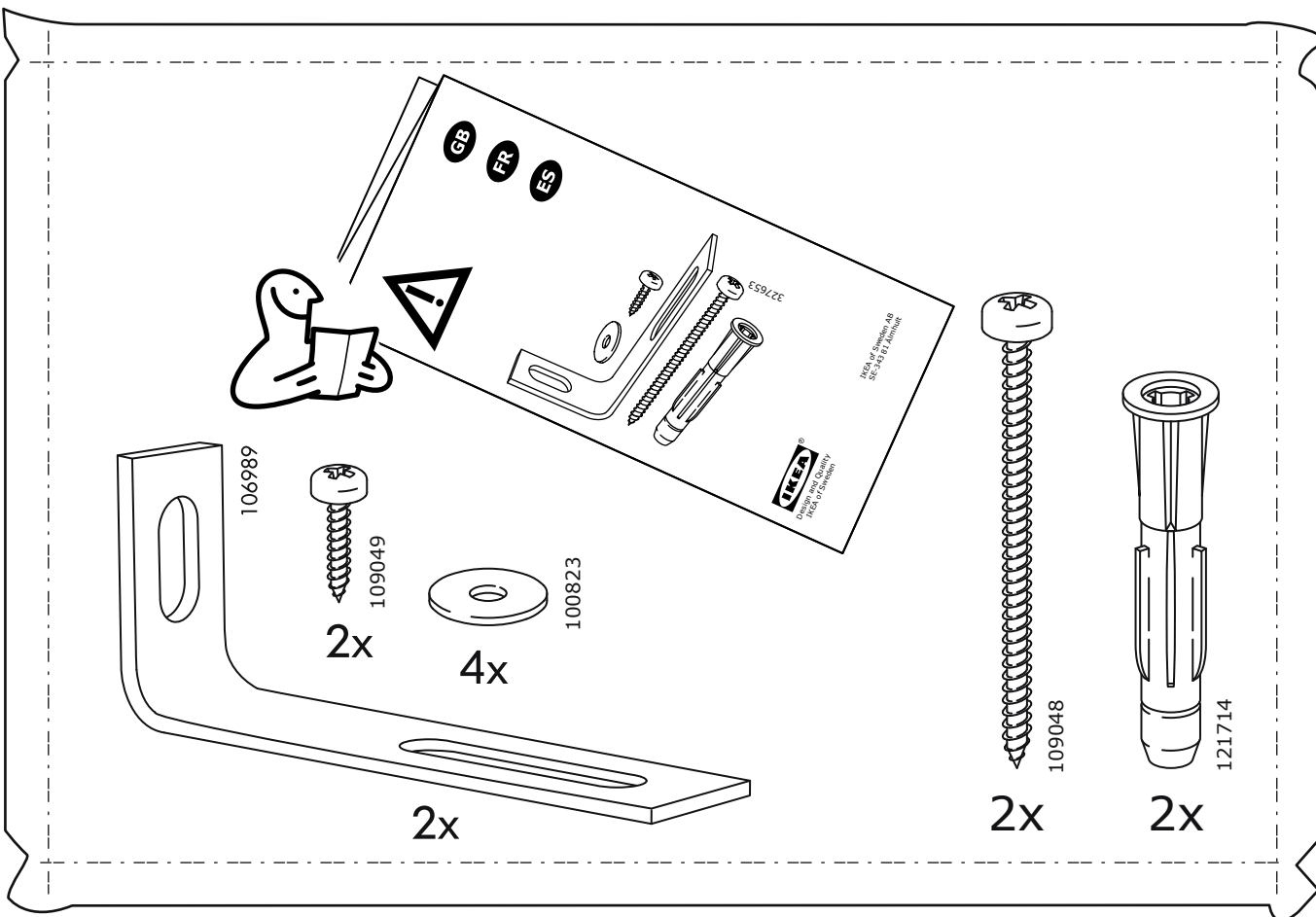
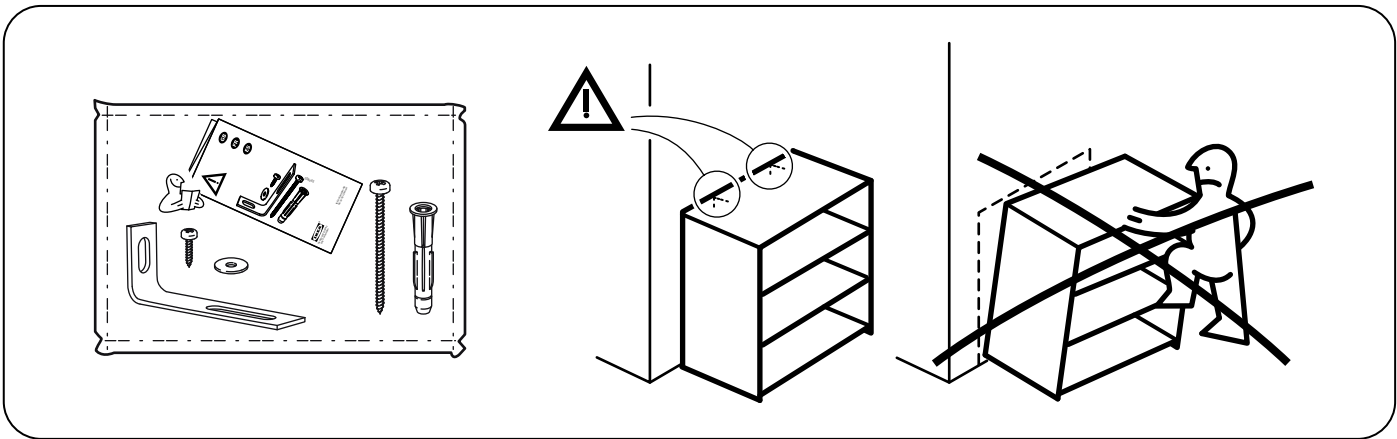
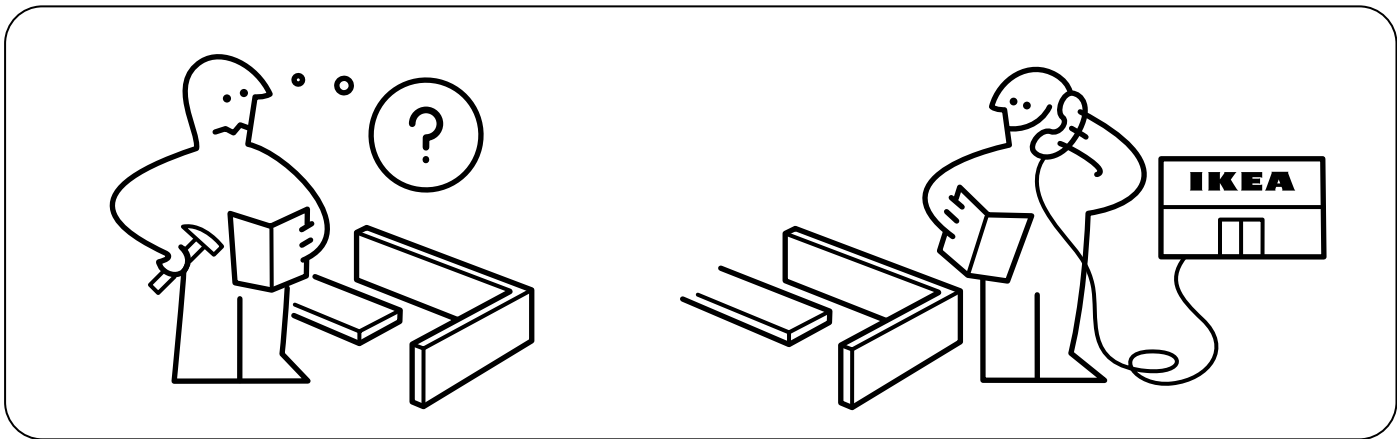

1

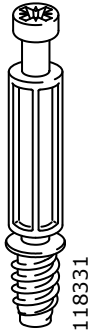

118331

17x

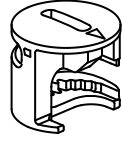

118137

17x

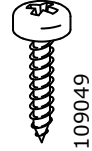

109049

7x

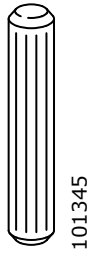

101345

14x

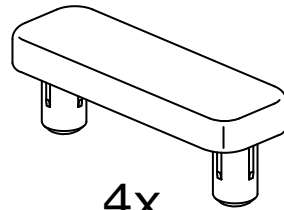

153549

4x

2



118331

16x

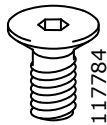

117784

6x



101345

13x



118137

16x

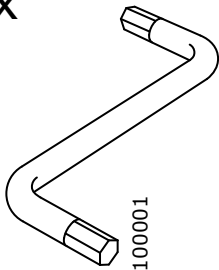

100001

1x

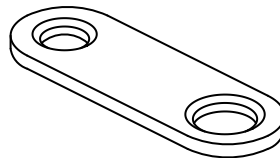

130444

3x

1

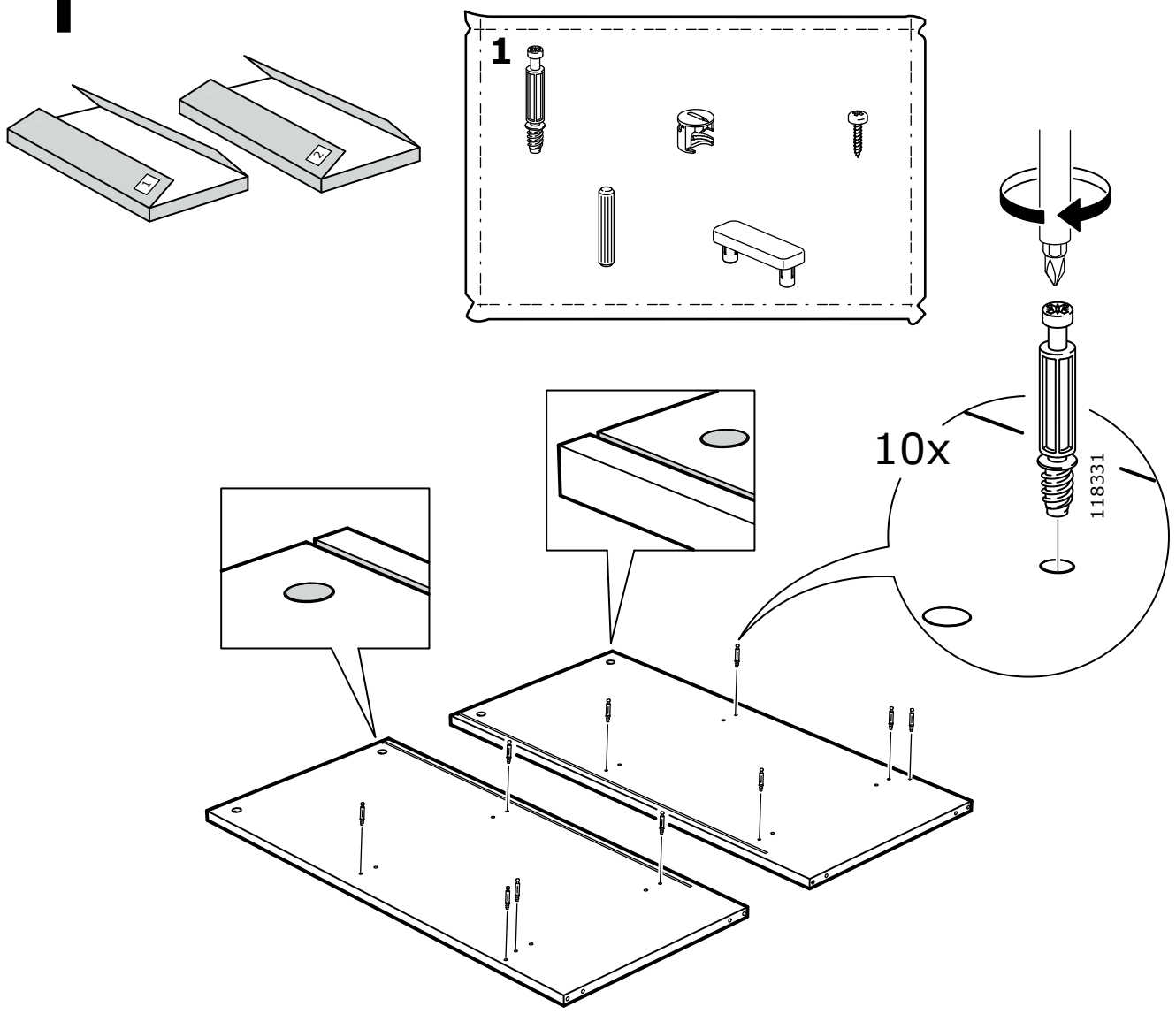

2

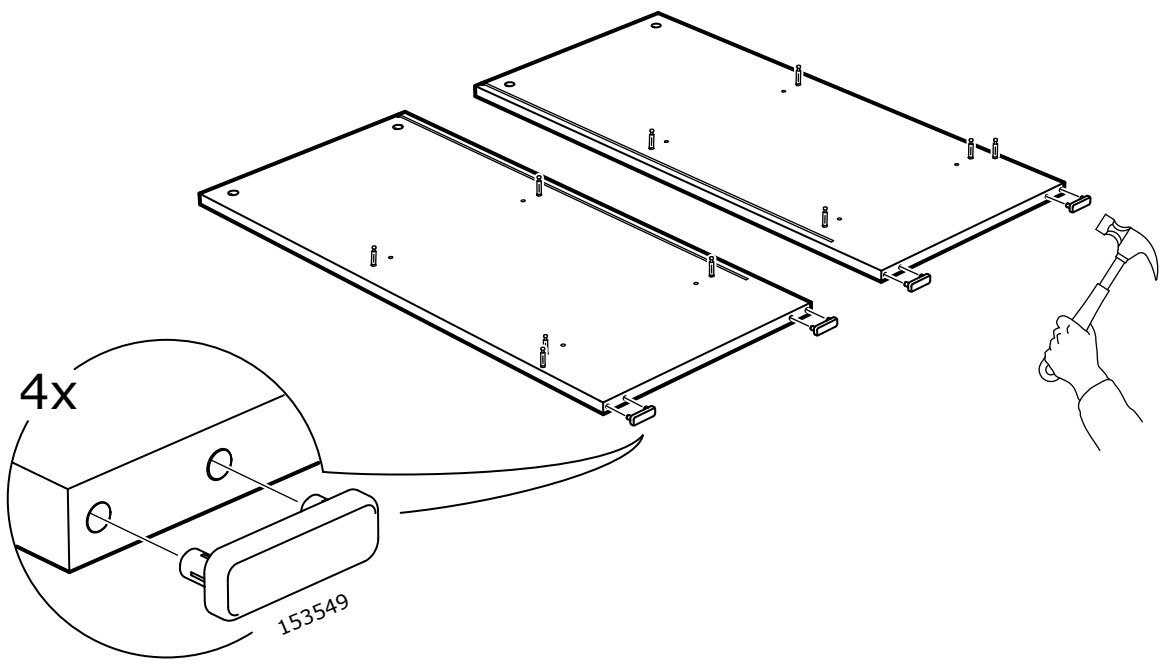

3

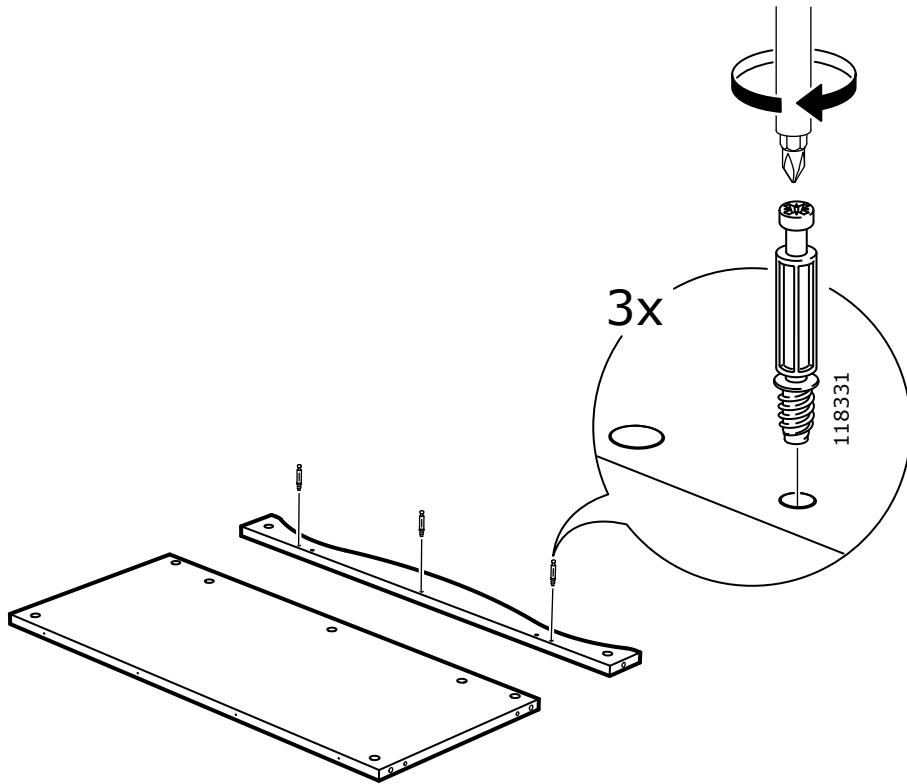

4

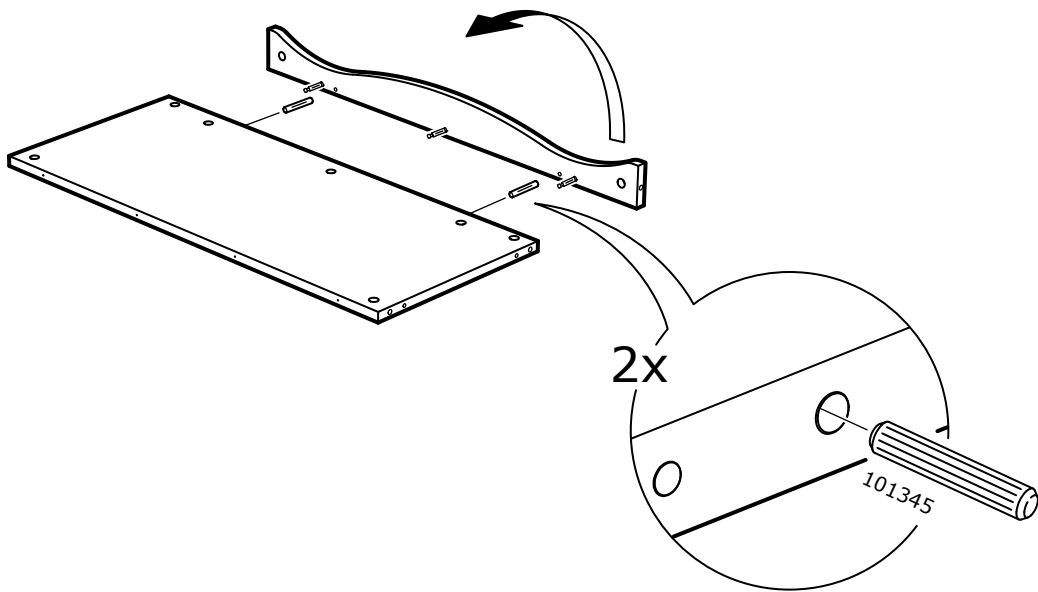

5

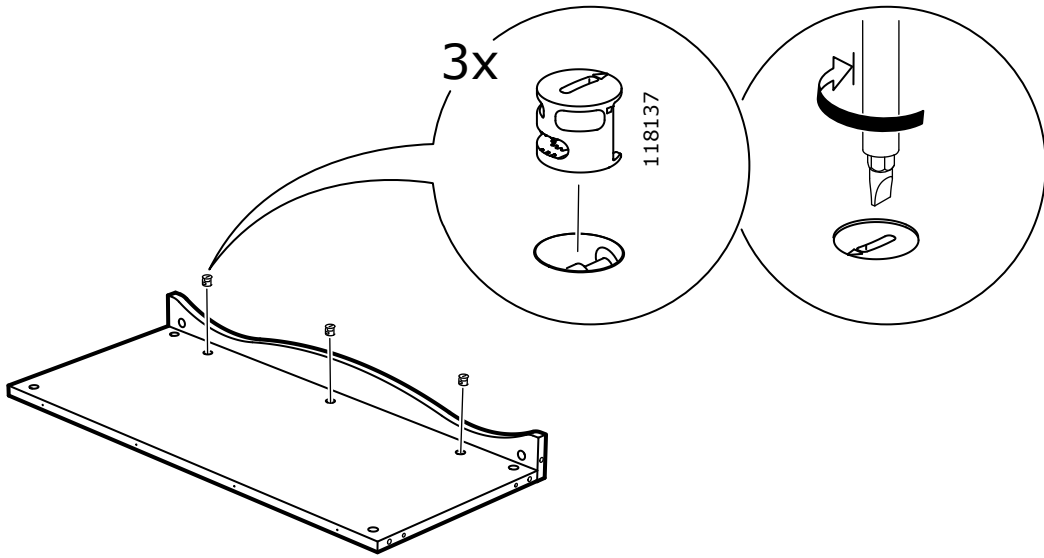

6

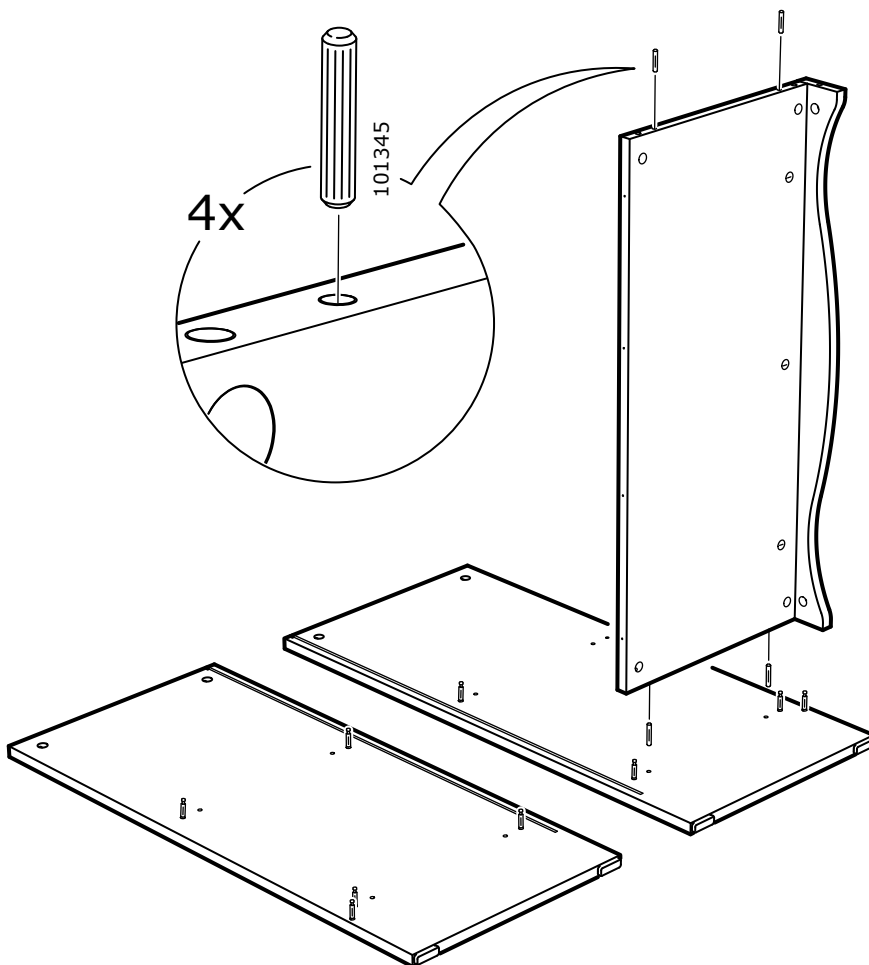

7

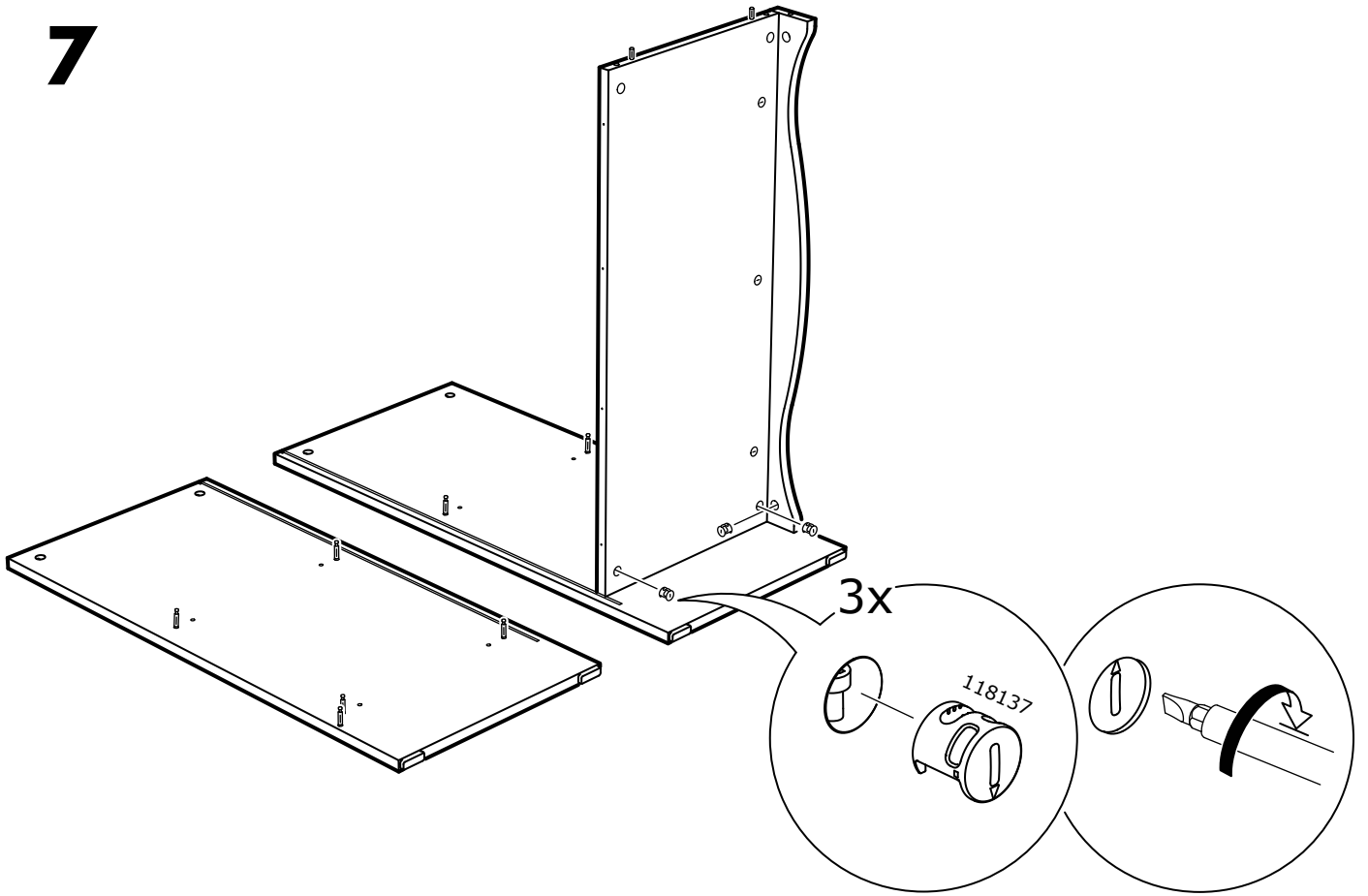

8

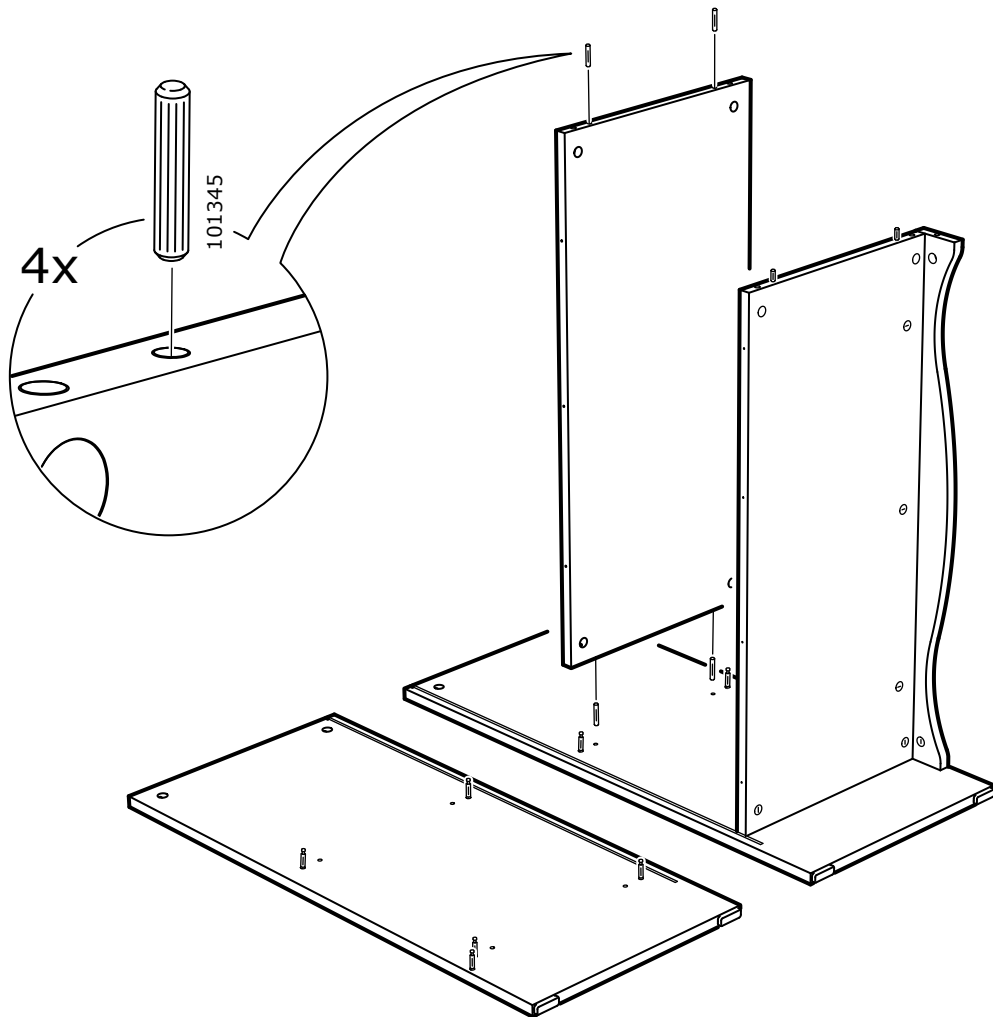

9

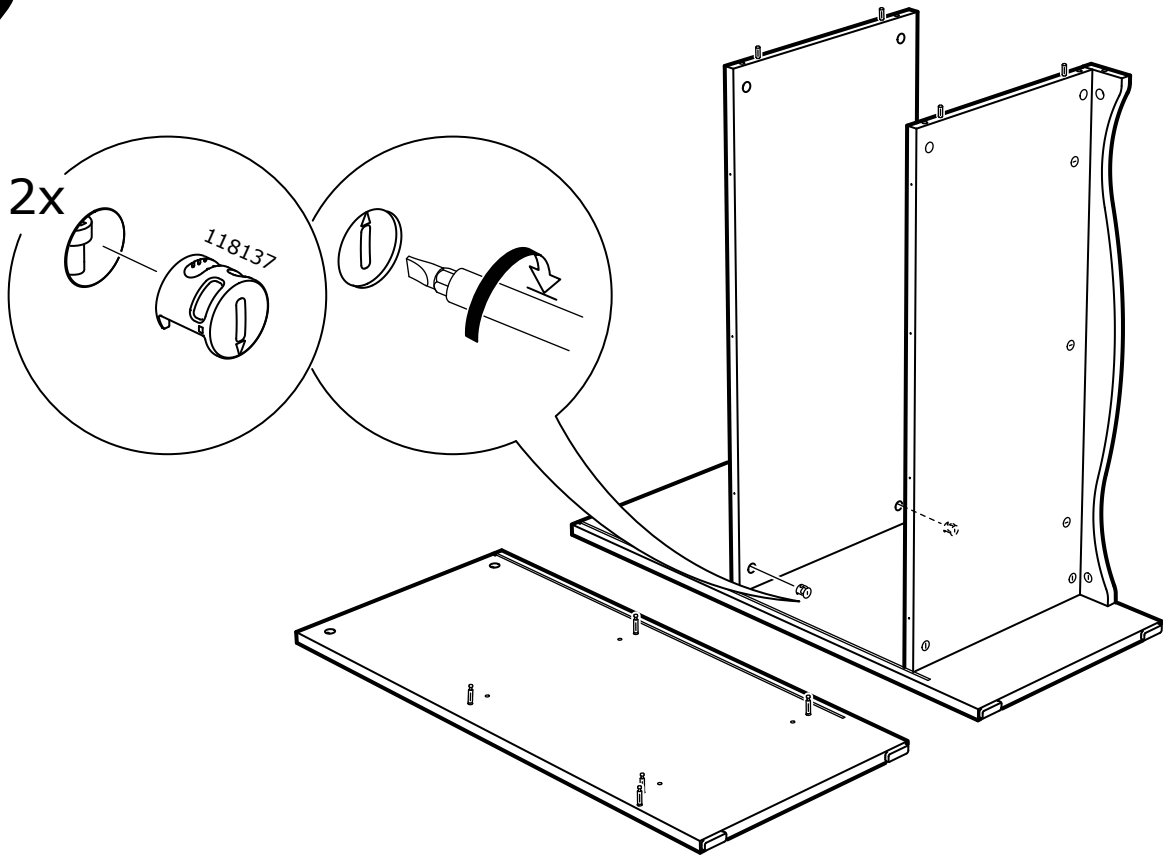

10

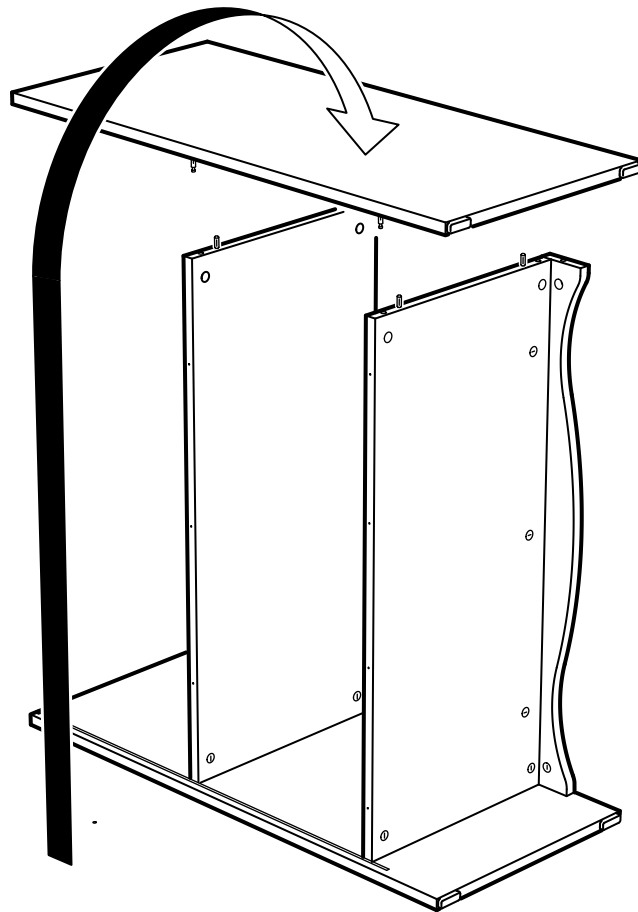

11

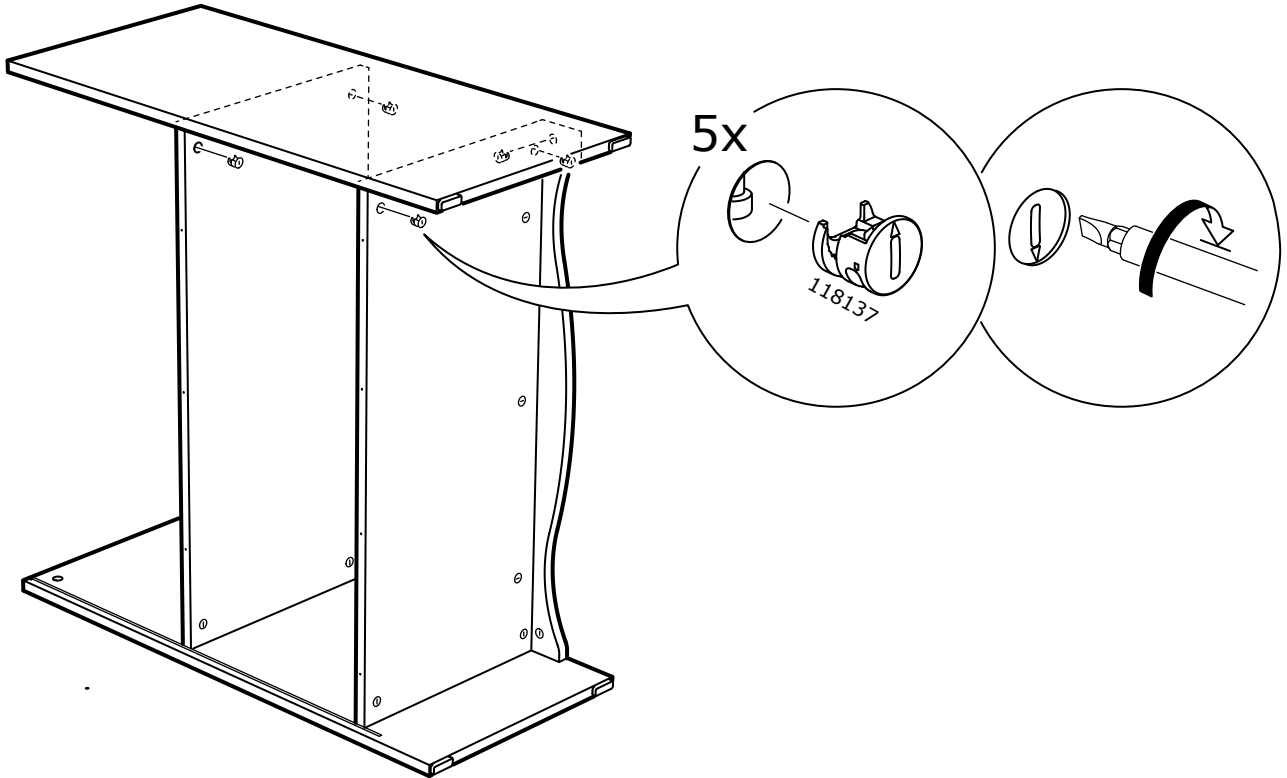

12

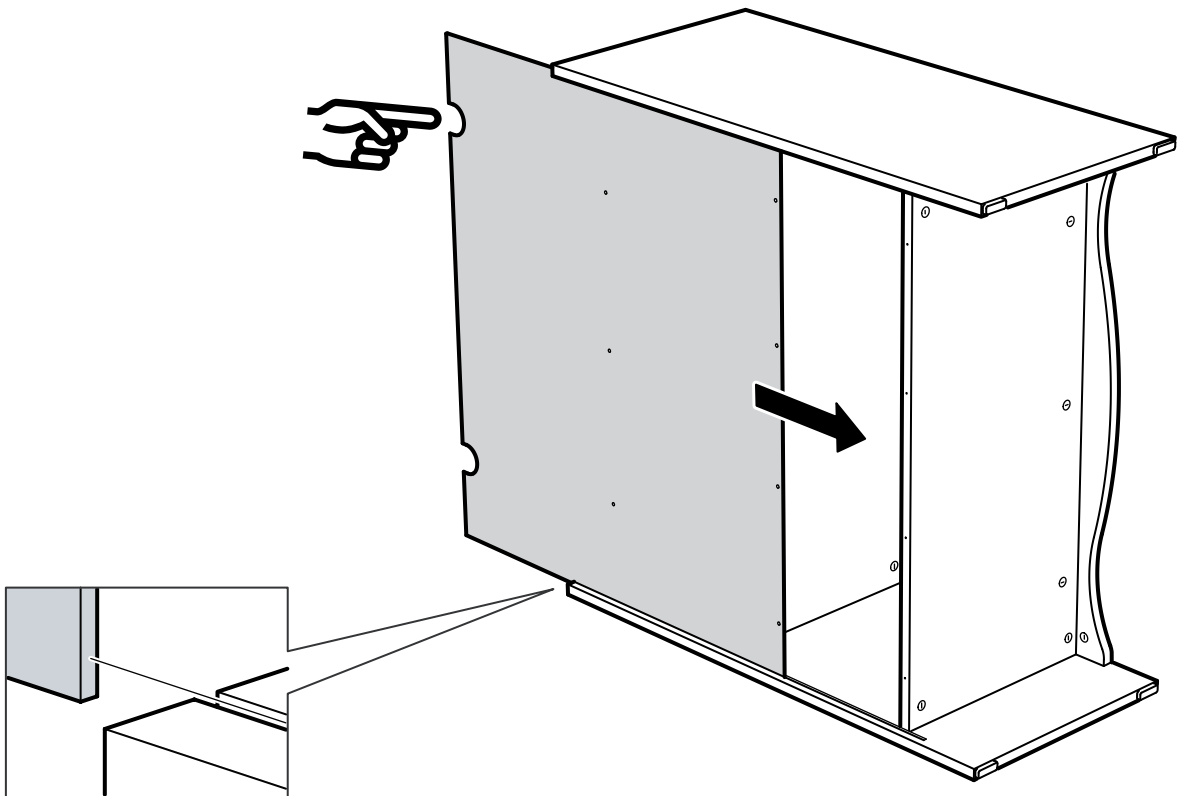

13

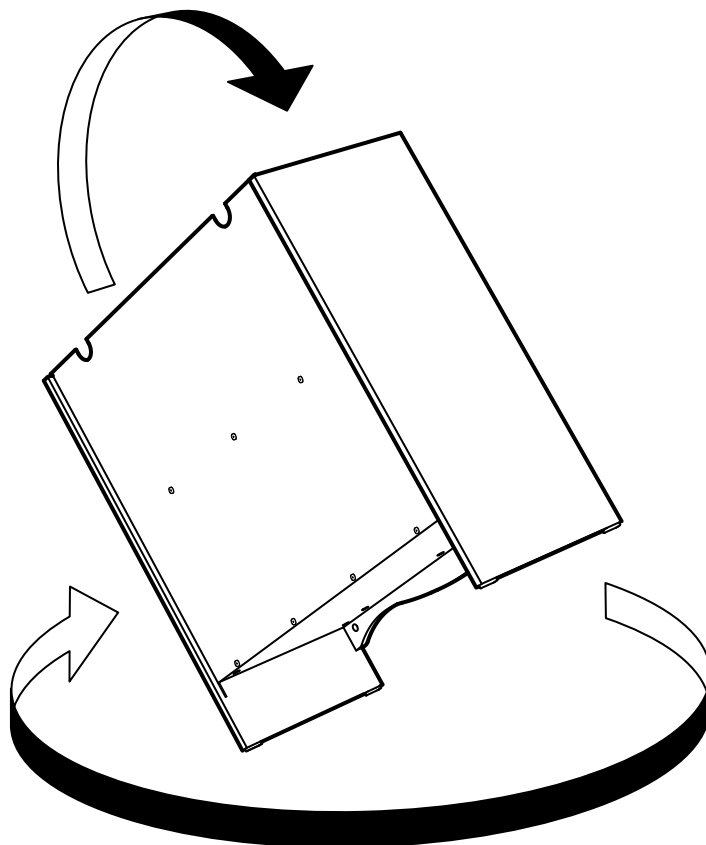
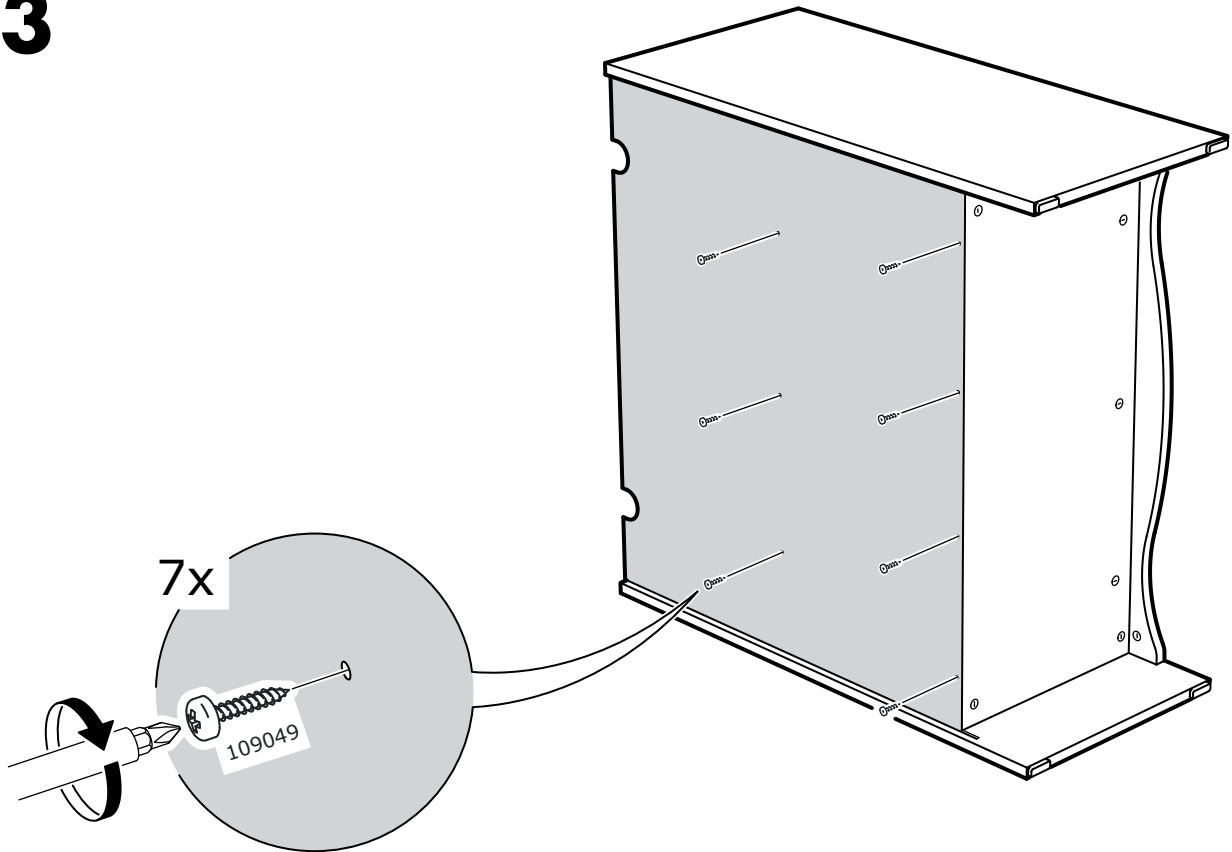

14

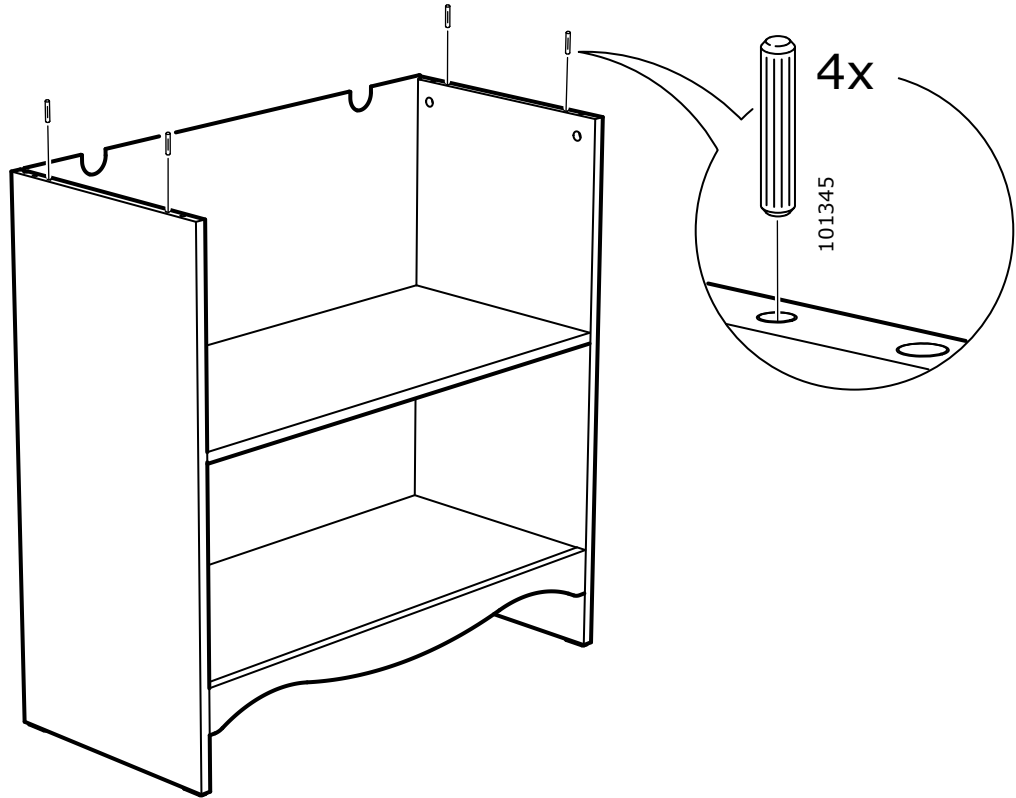

15

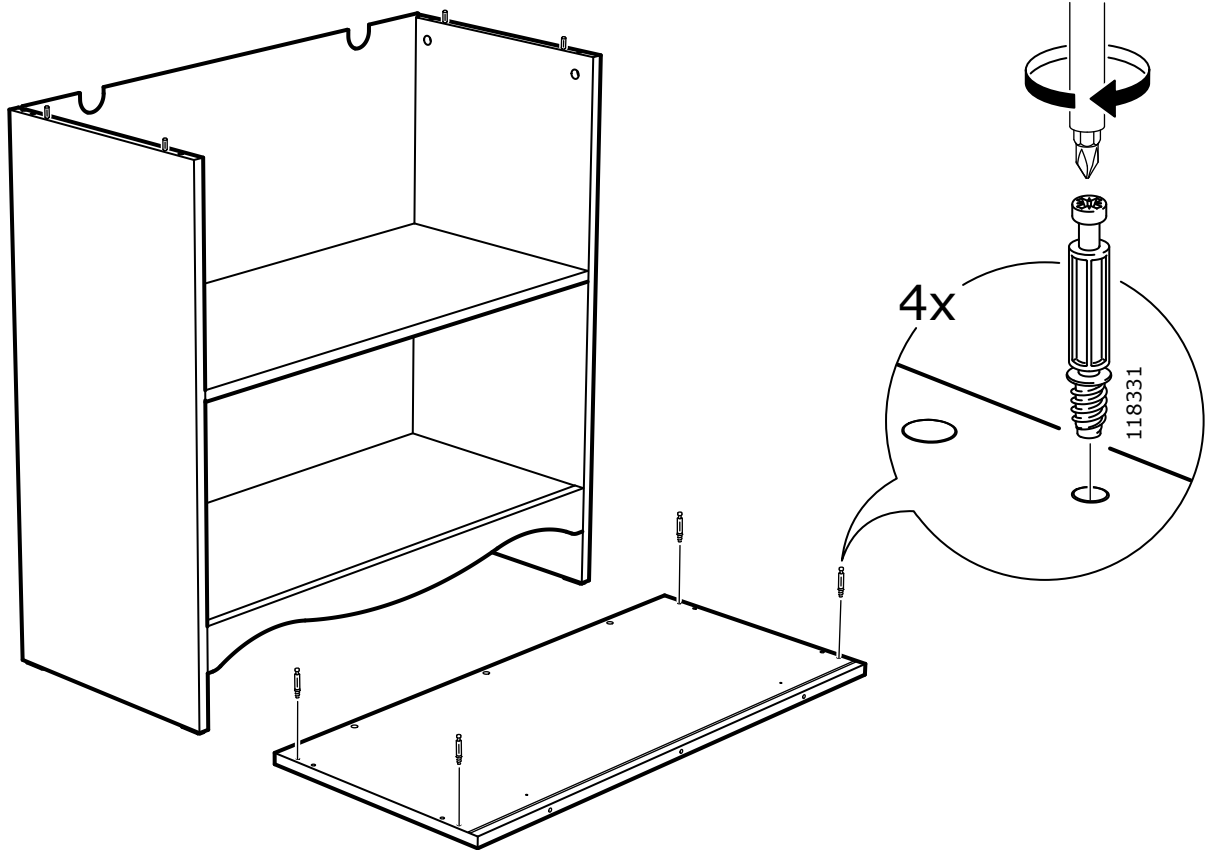

16

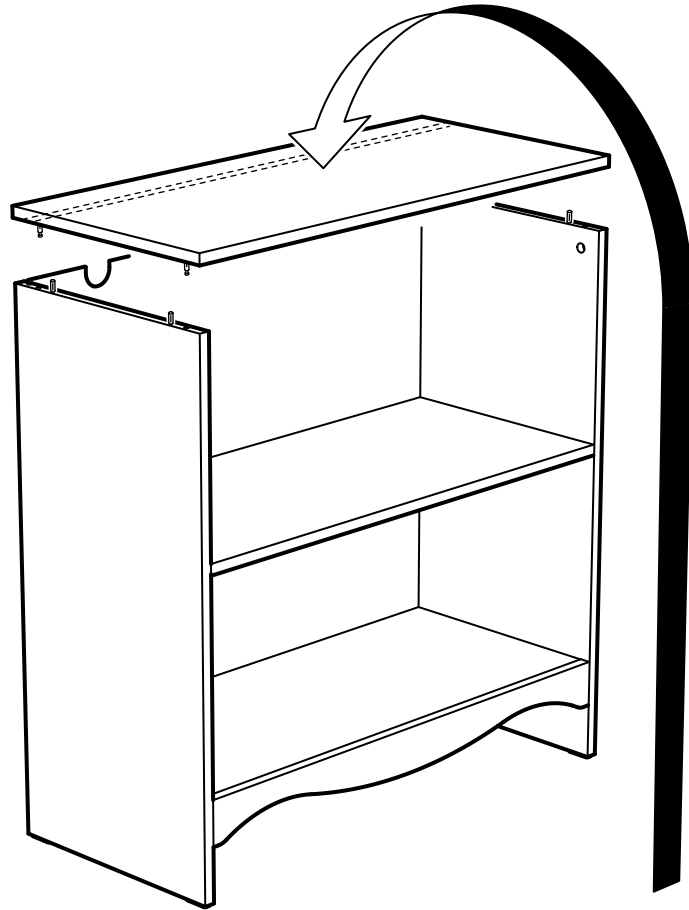

17

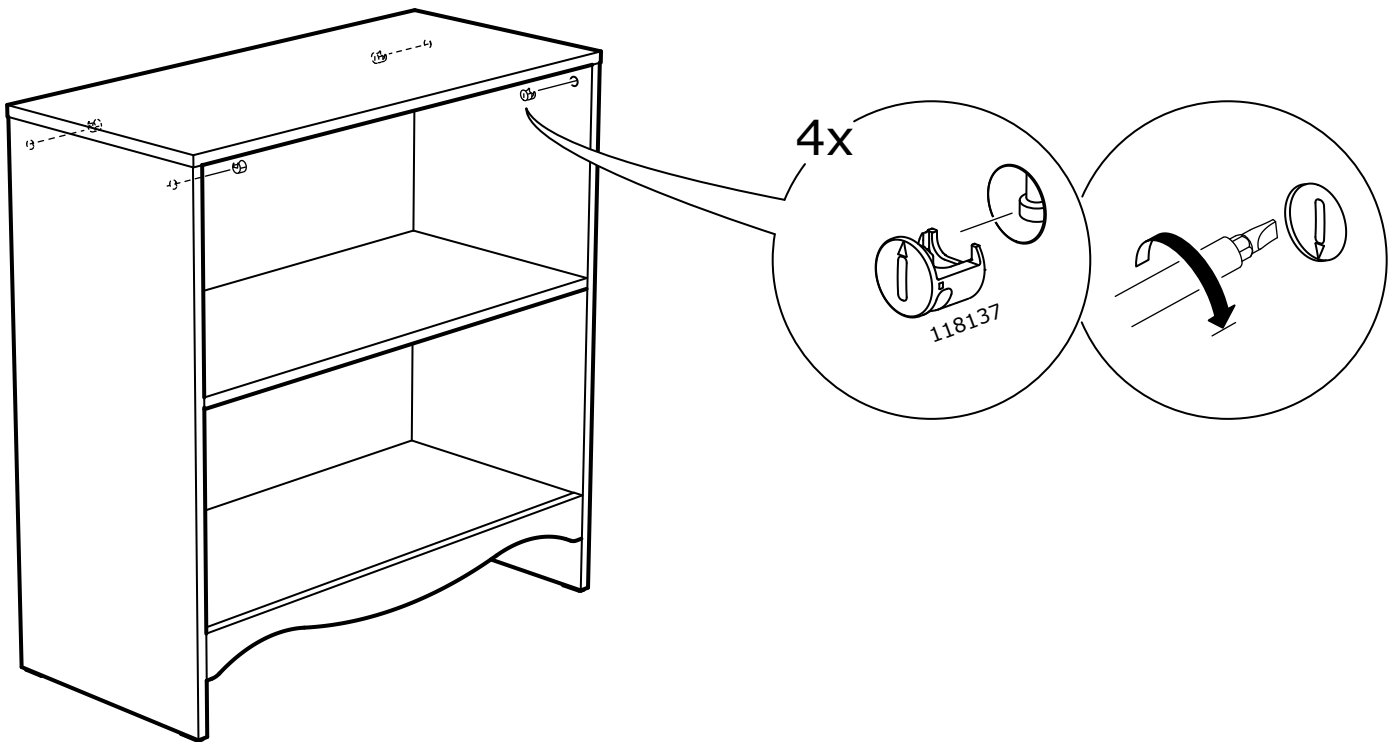

18

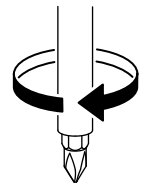
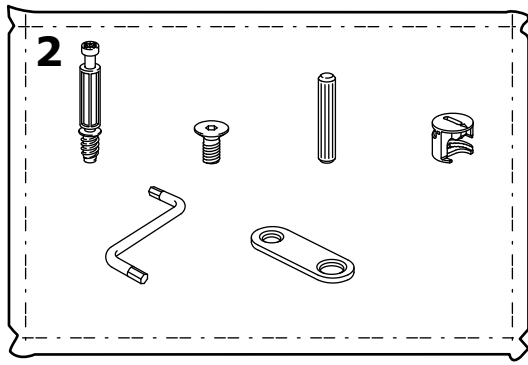

8x

118331

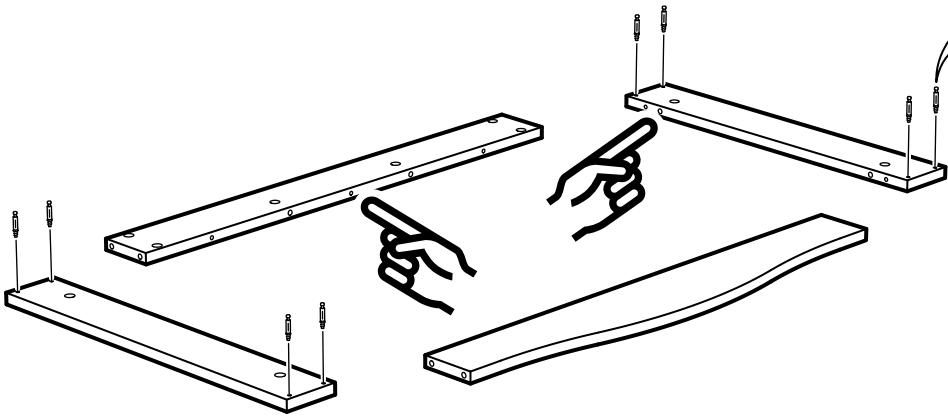

19

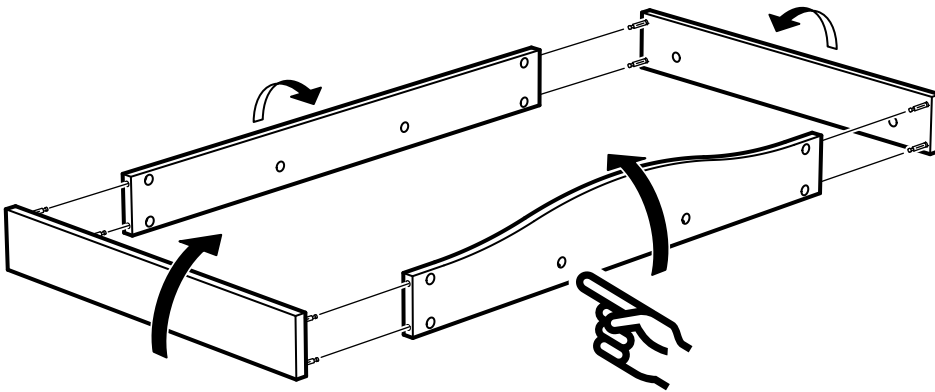

20

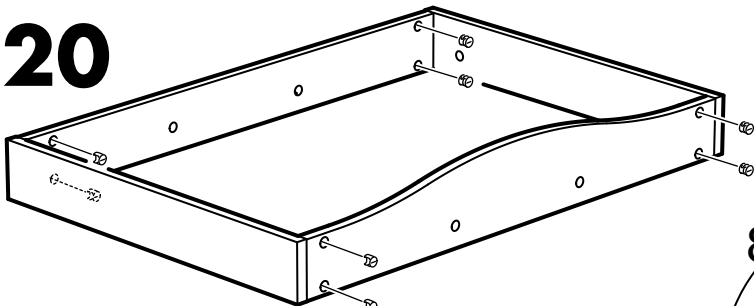

8x

118137

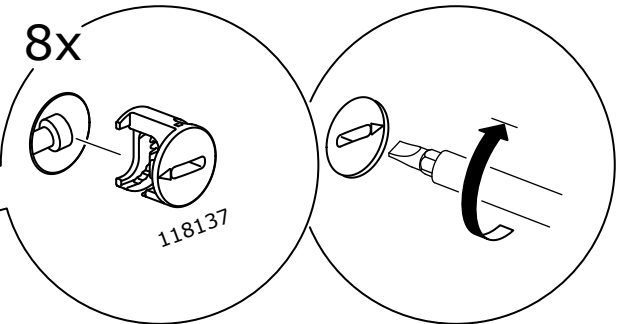

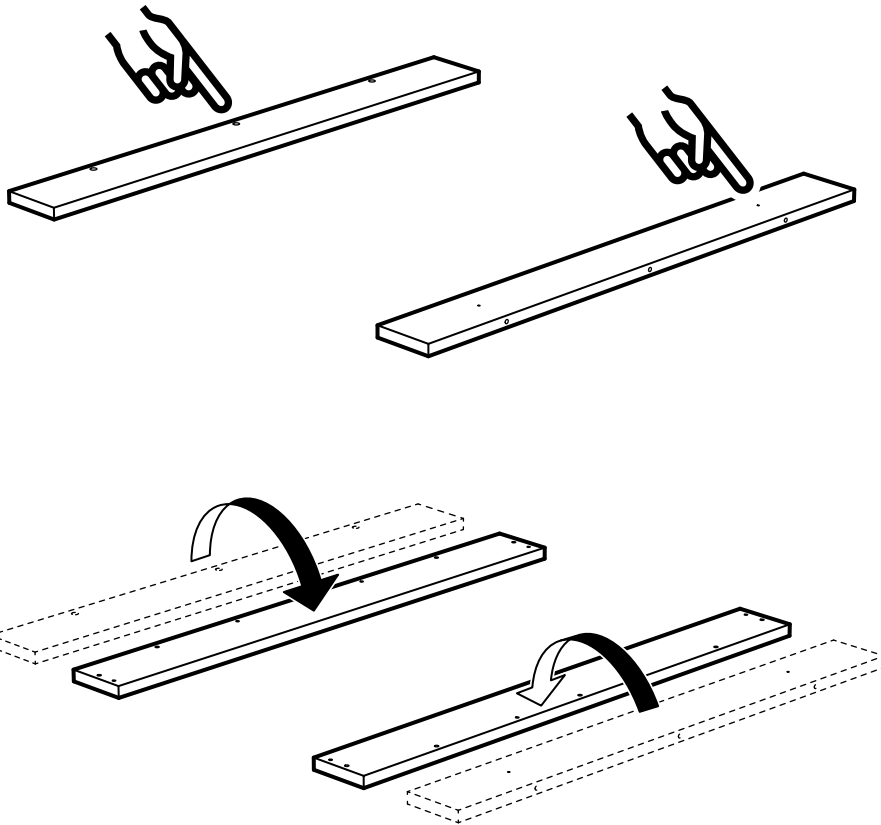

21

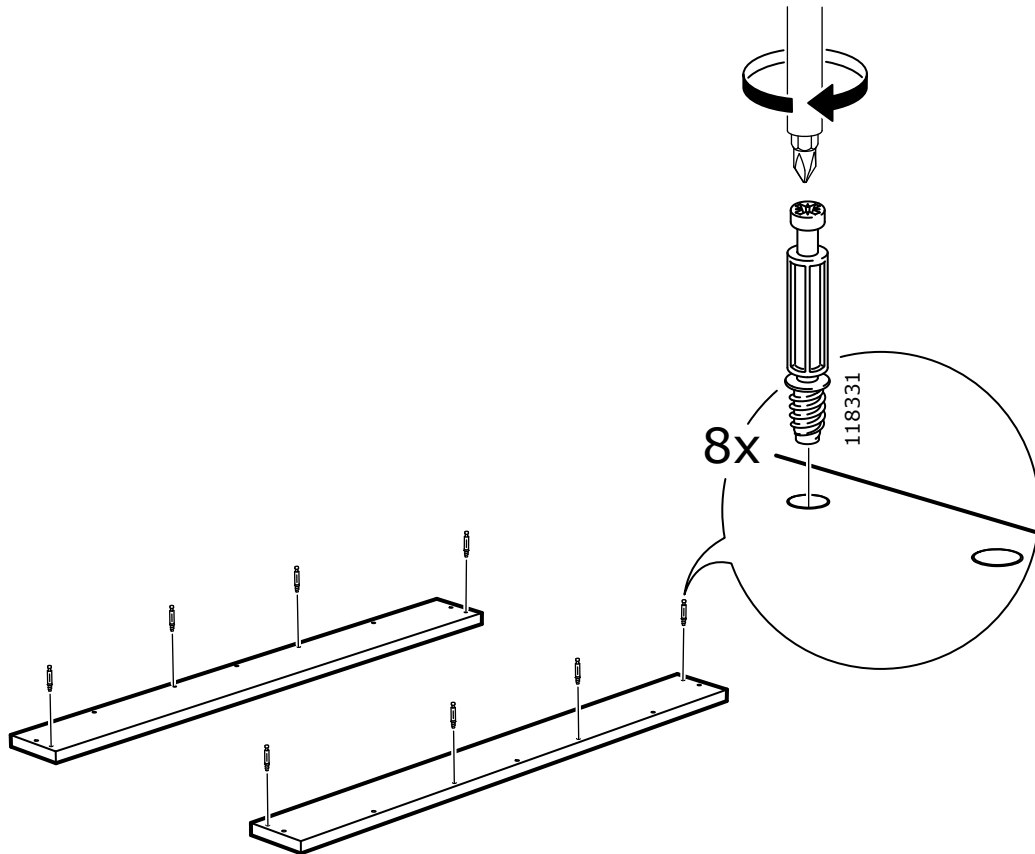

22

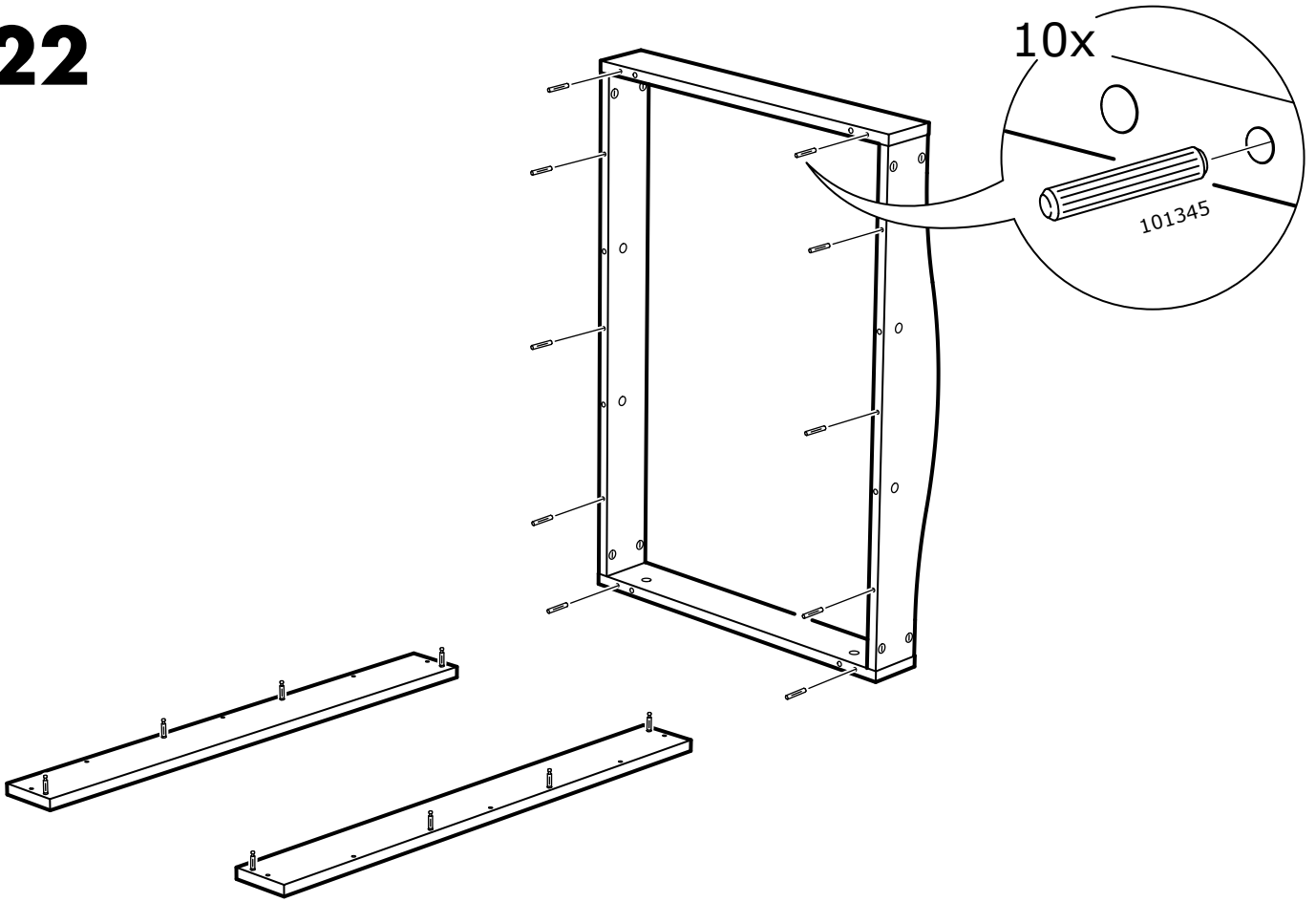

23

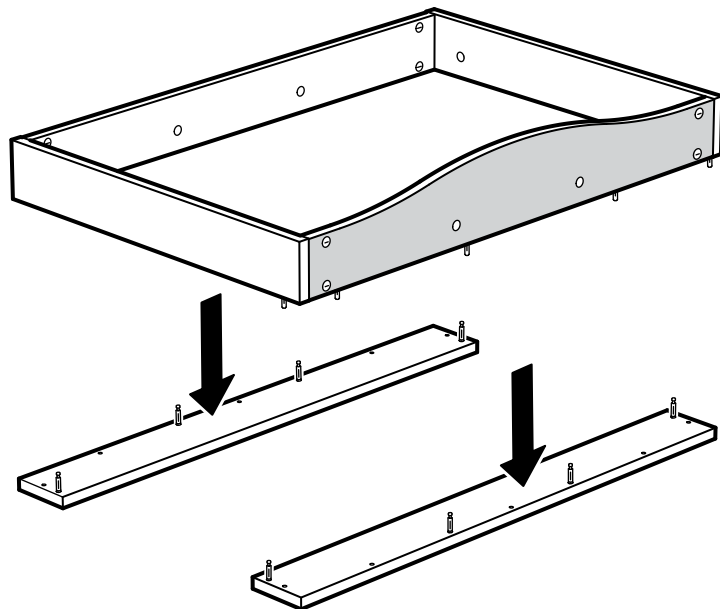

24

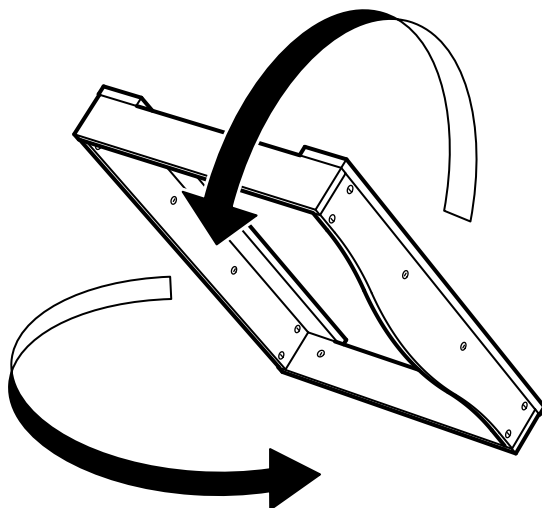
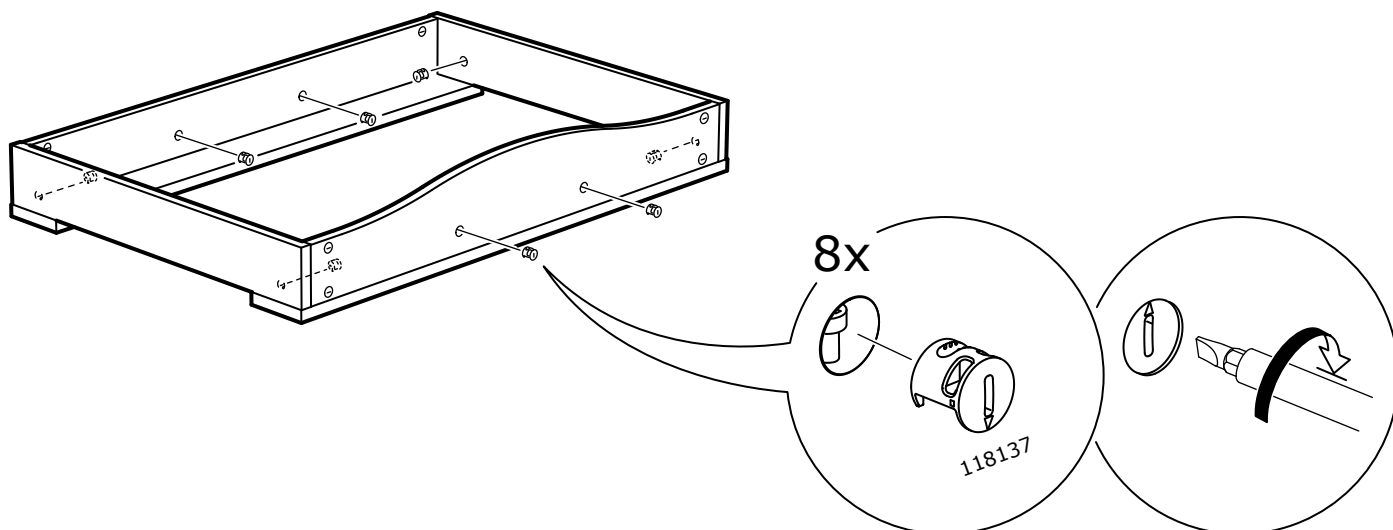

25

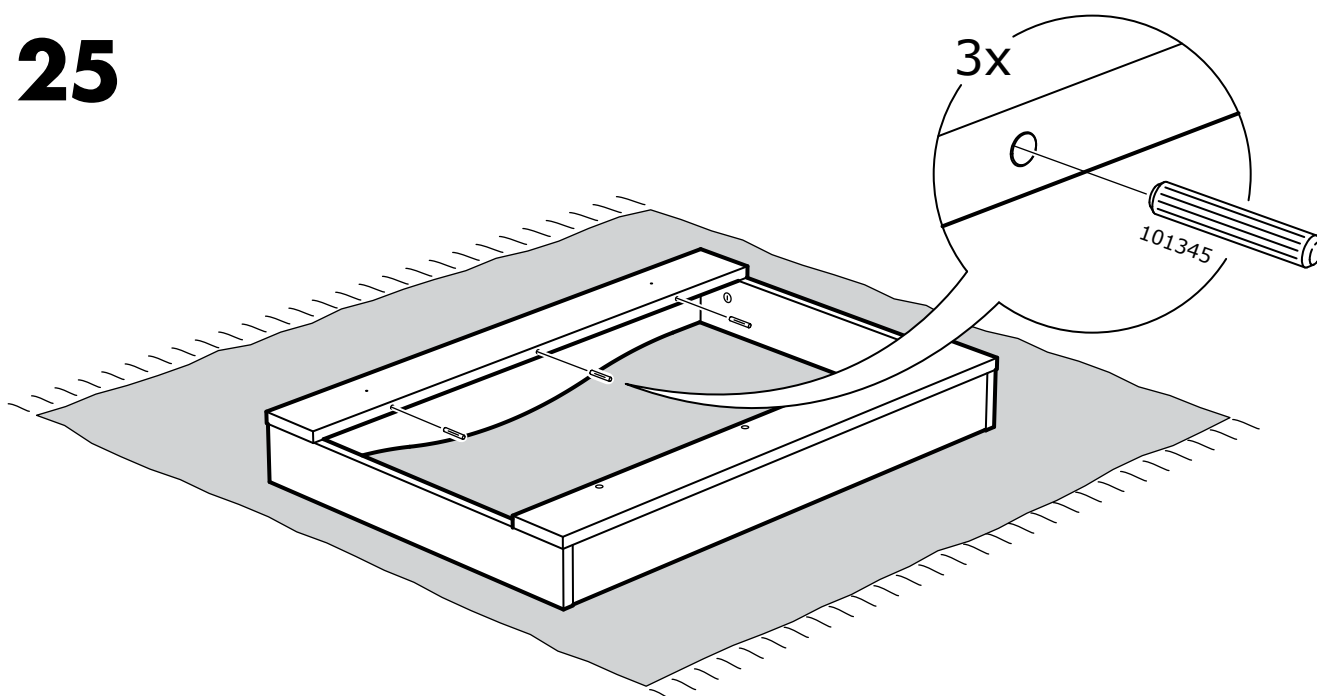

26

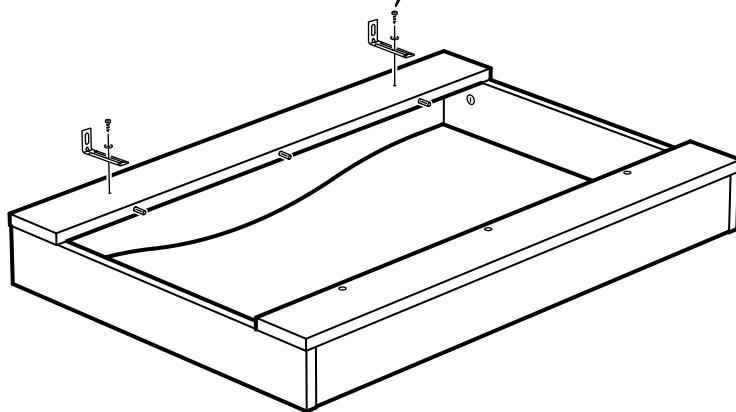
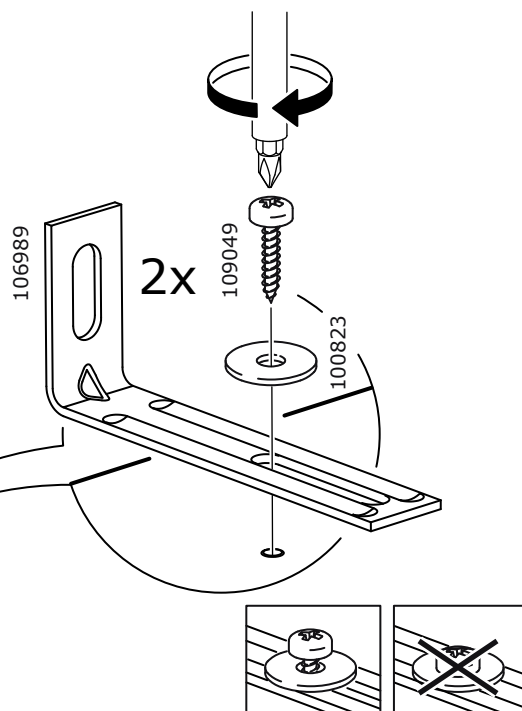
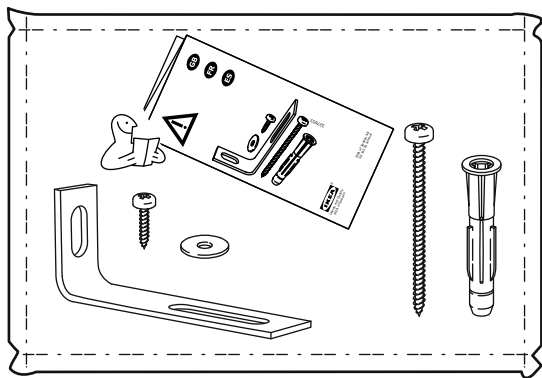

27

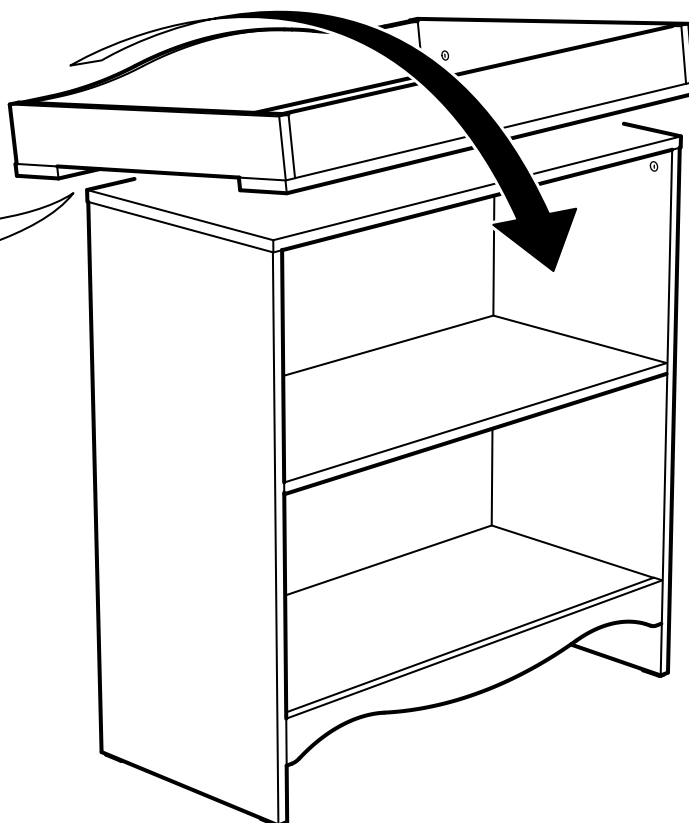
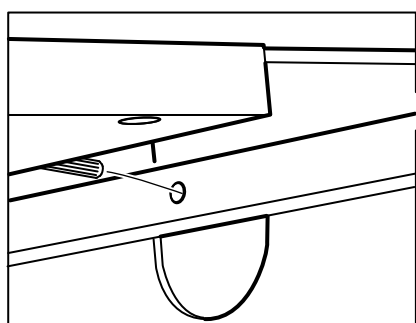

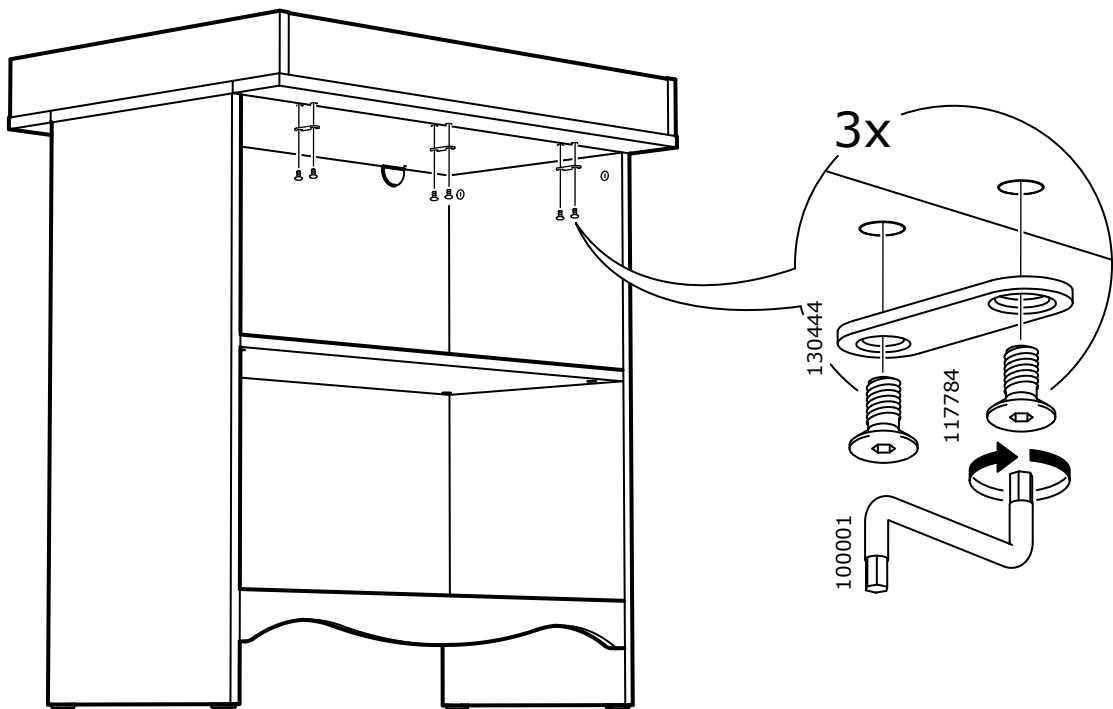

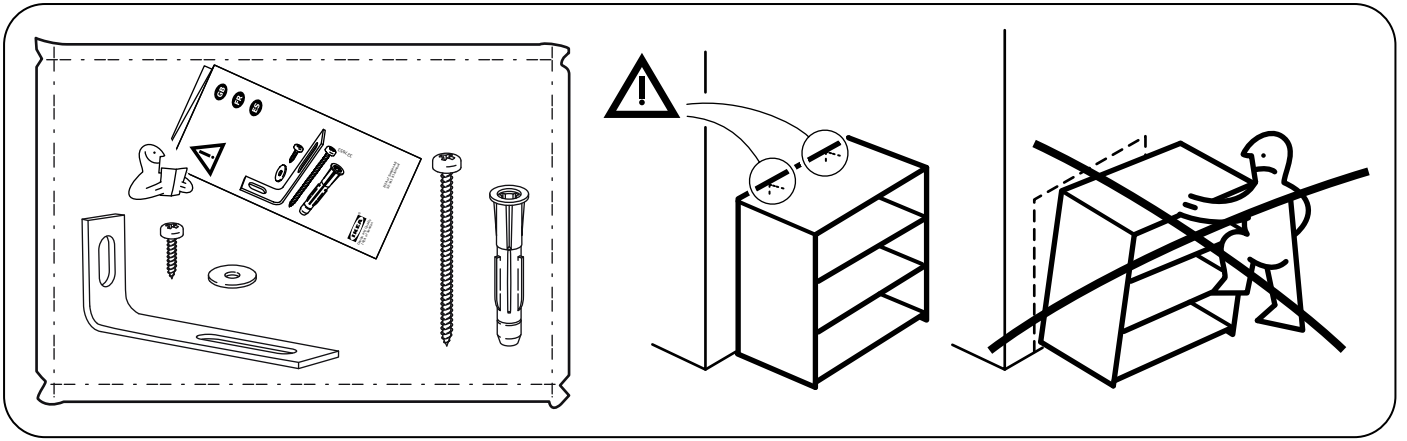

29

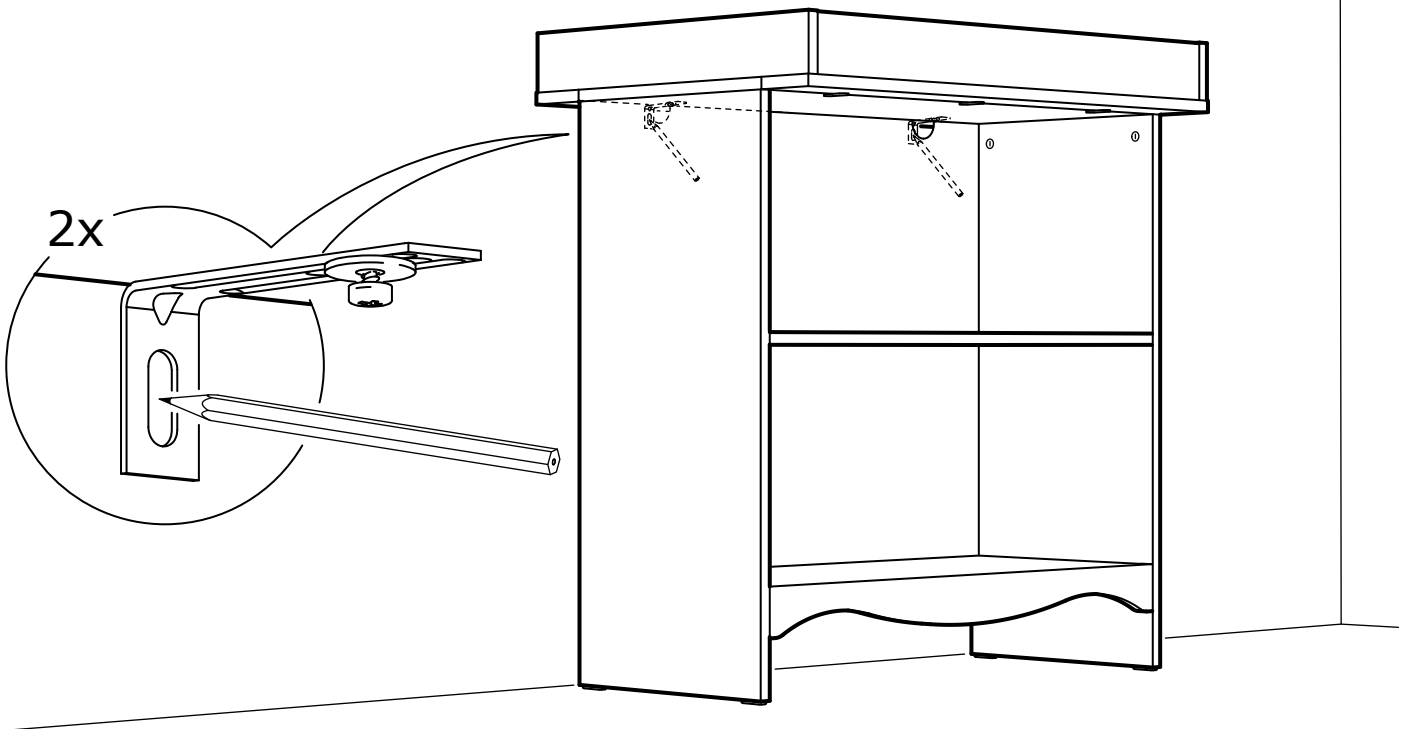
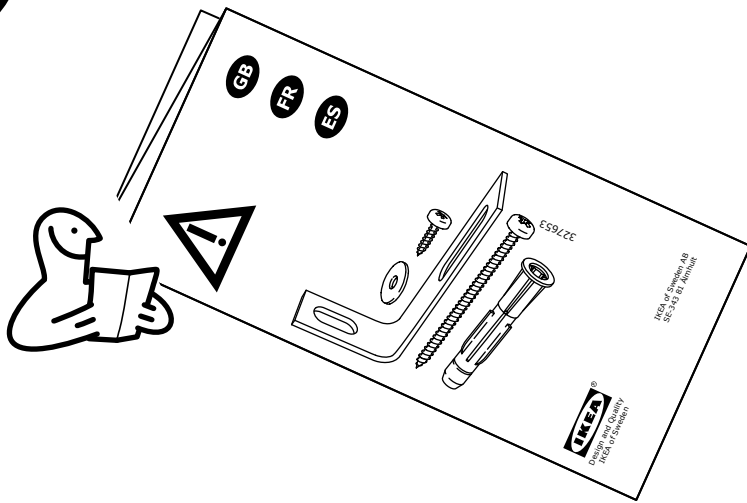

30

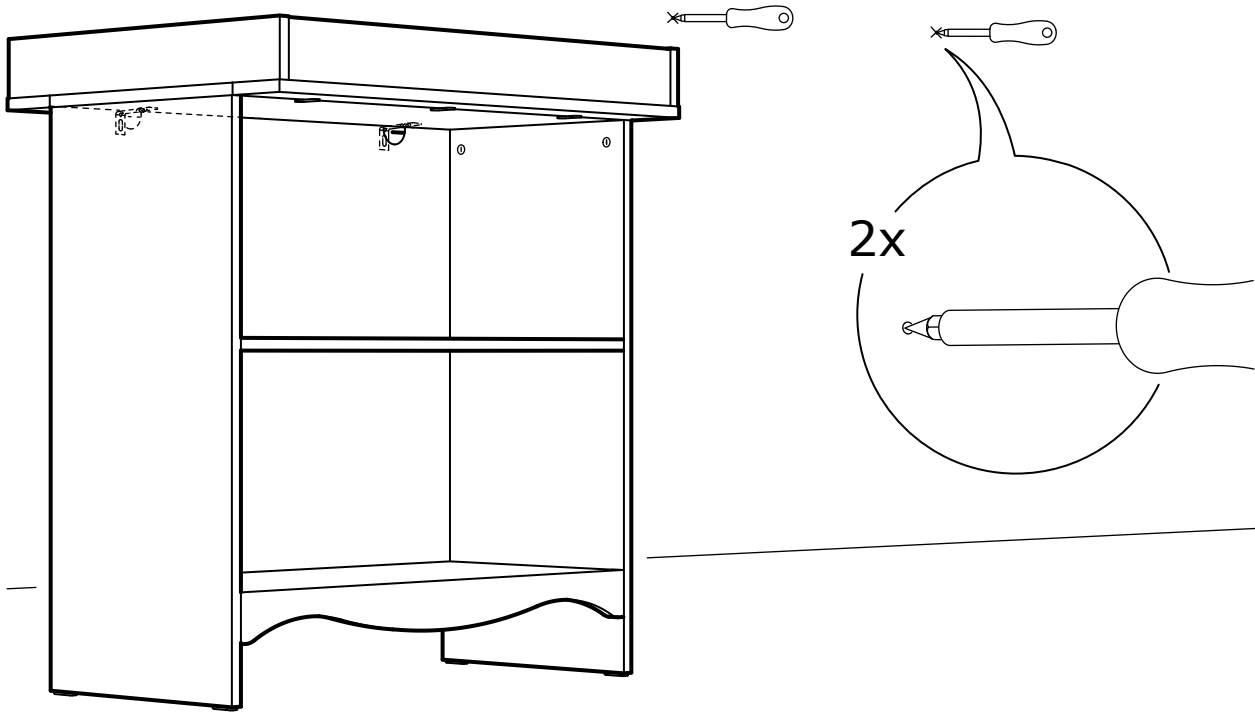

31

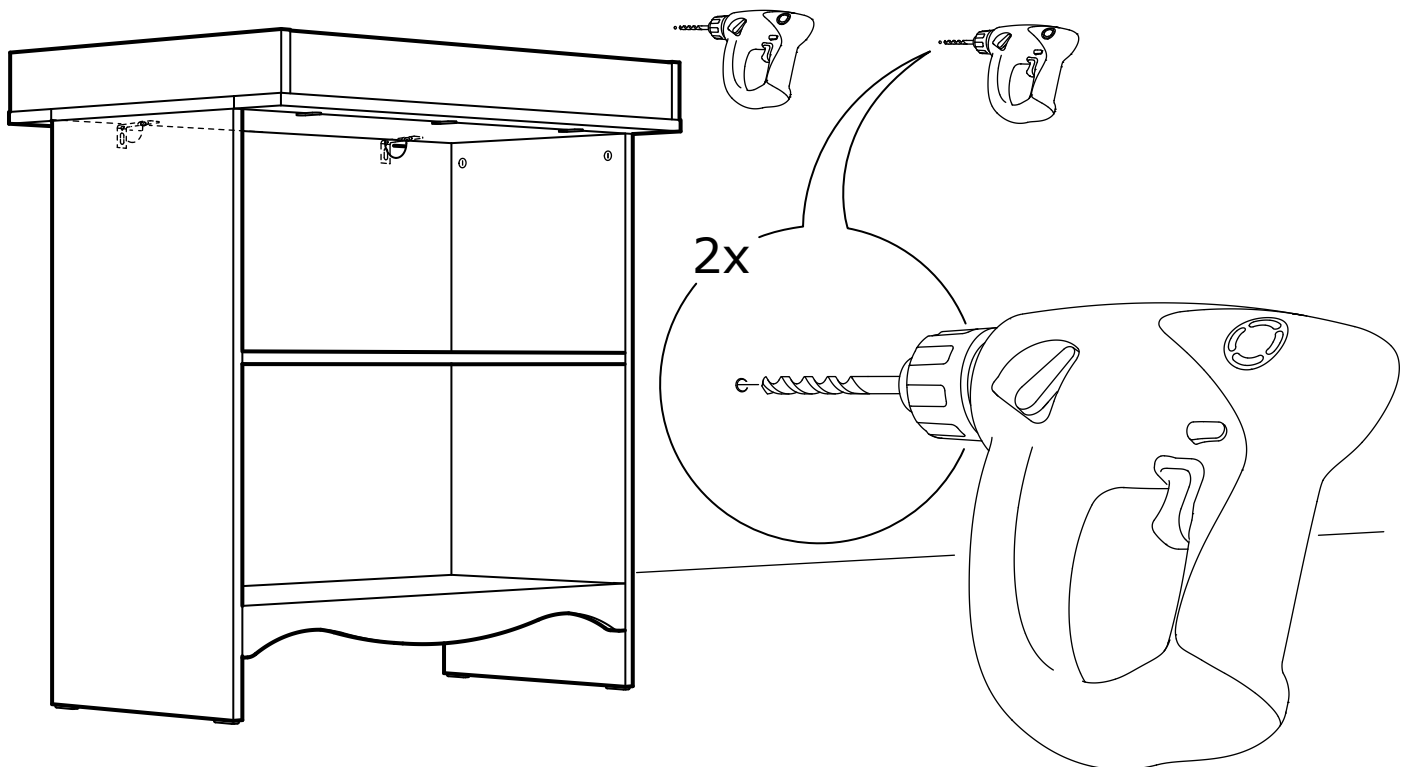

32

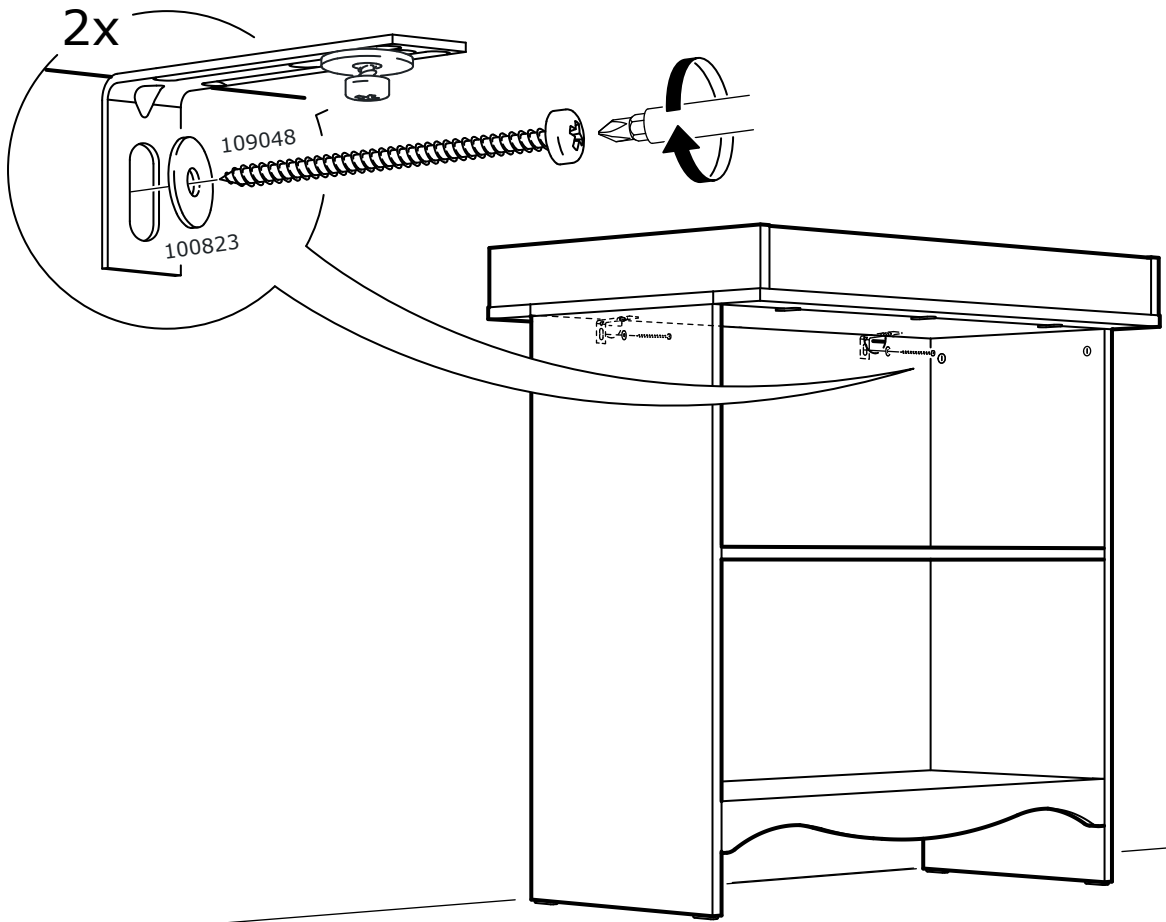

33

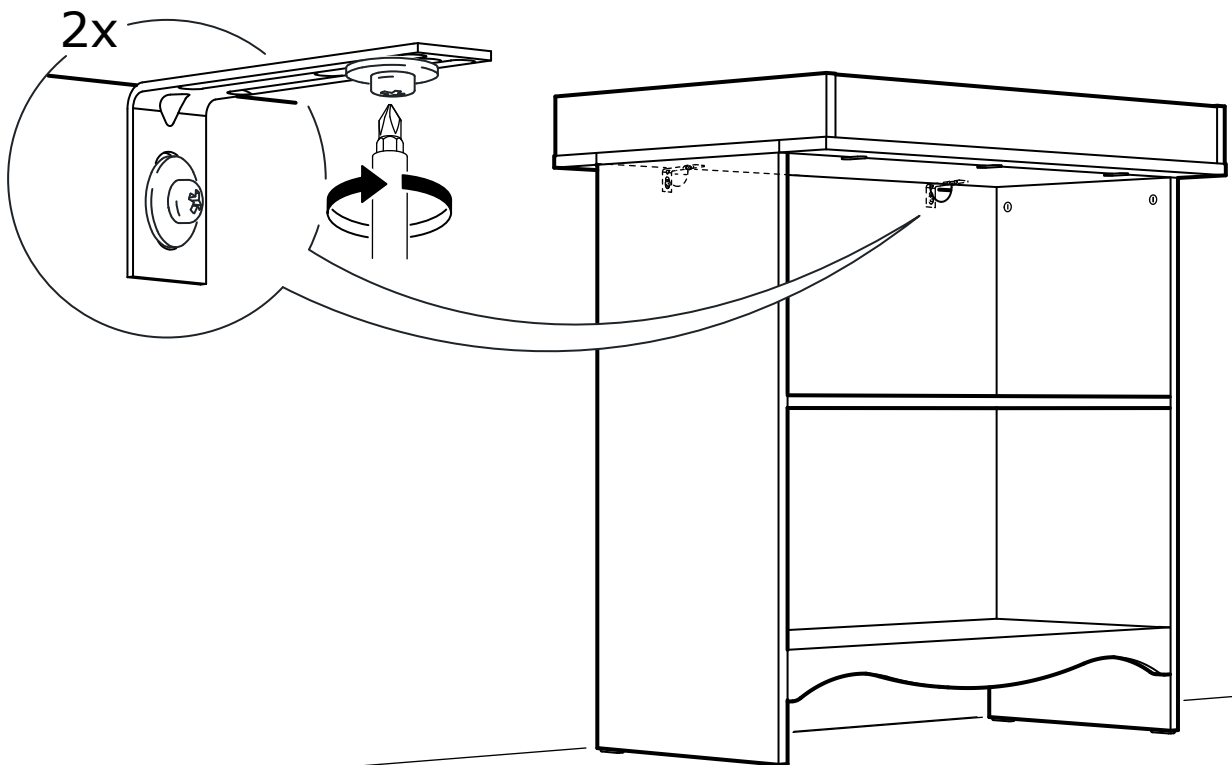

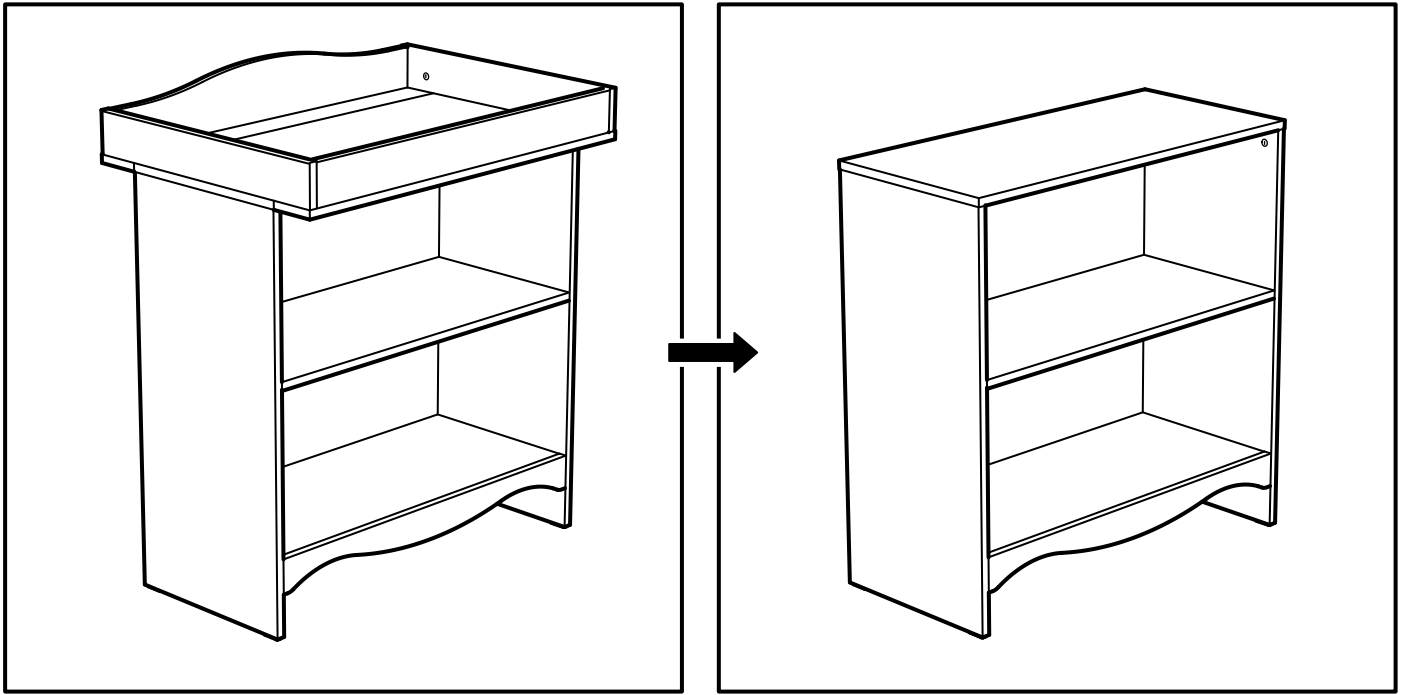

1

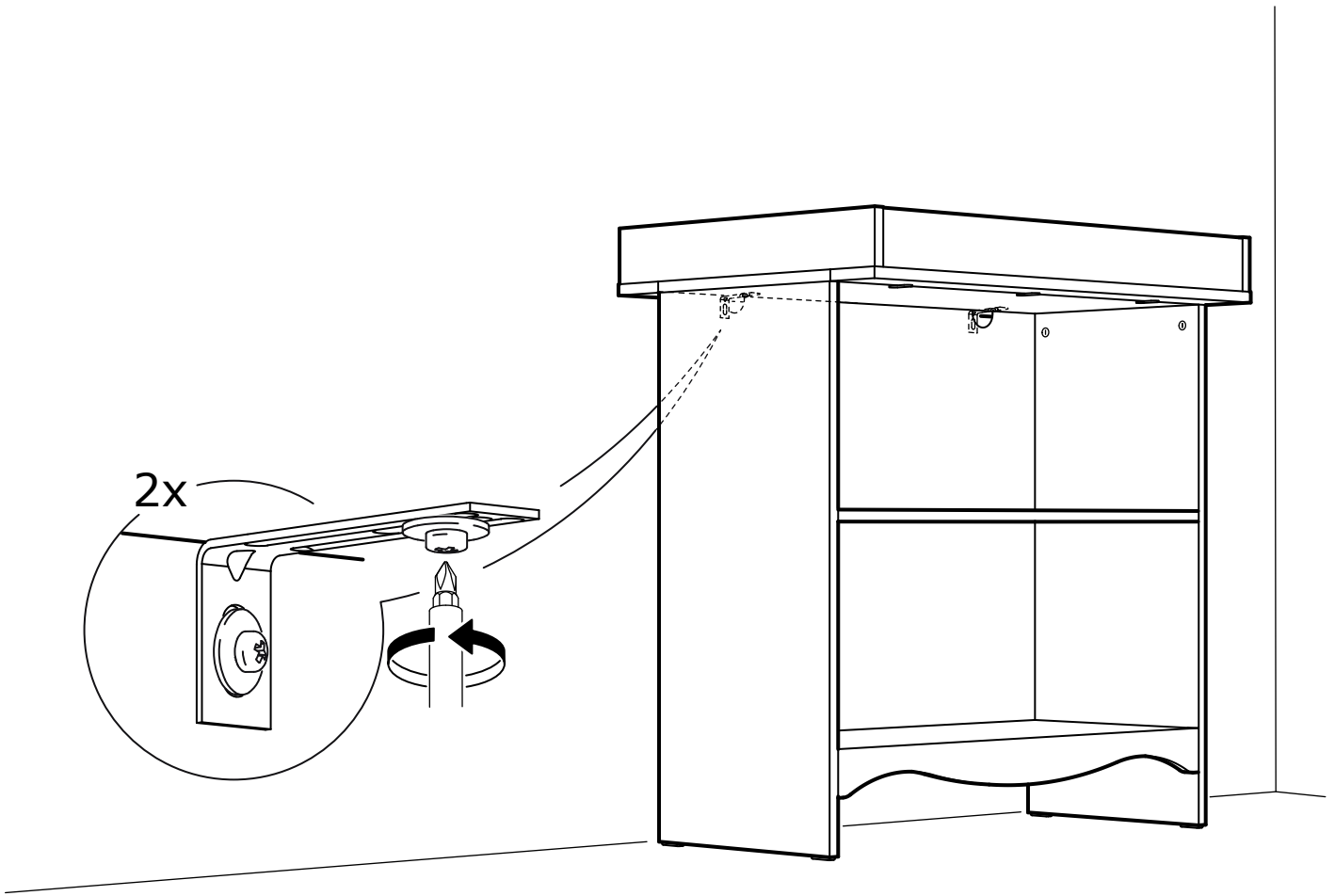

2

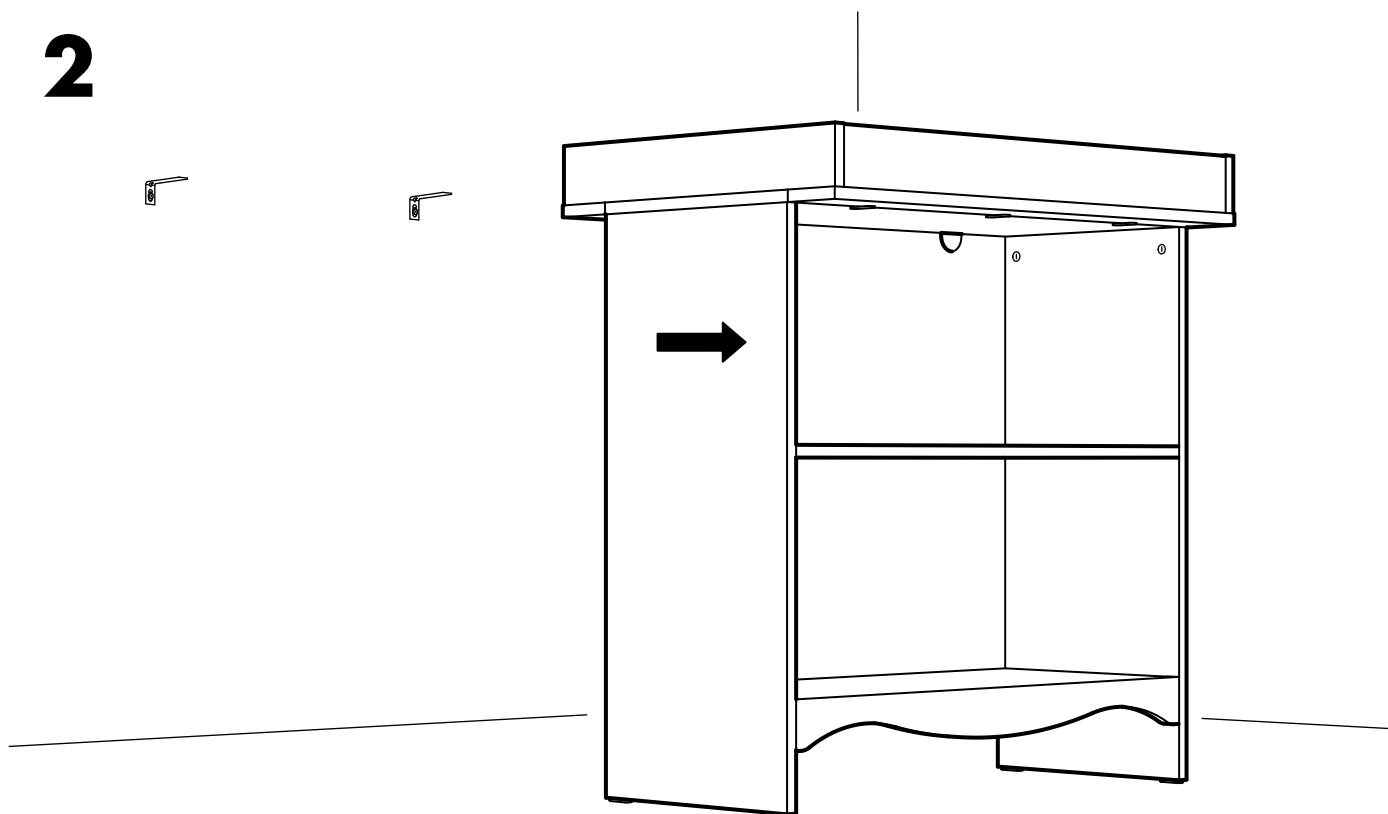

3

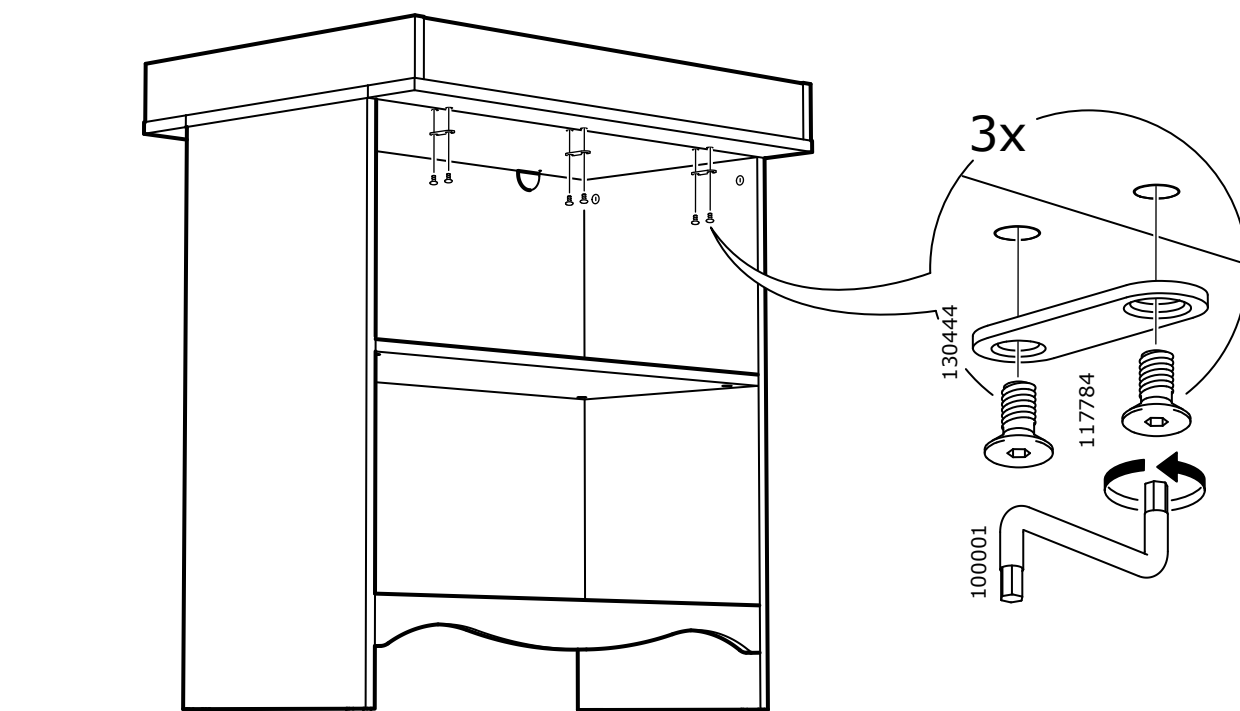

4

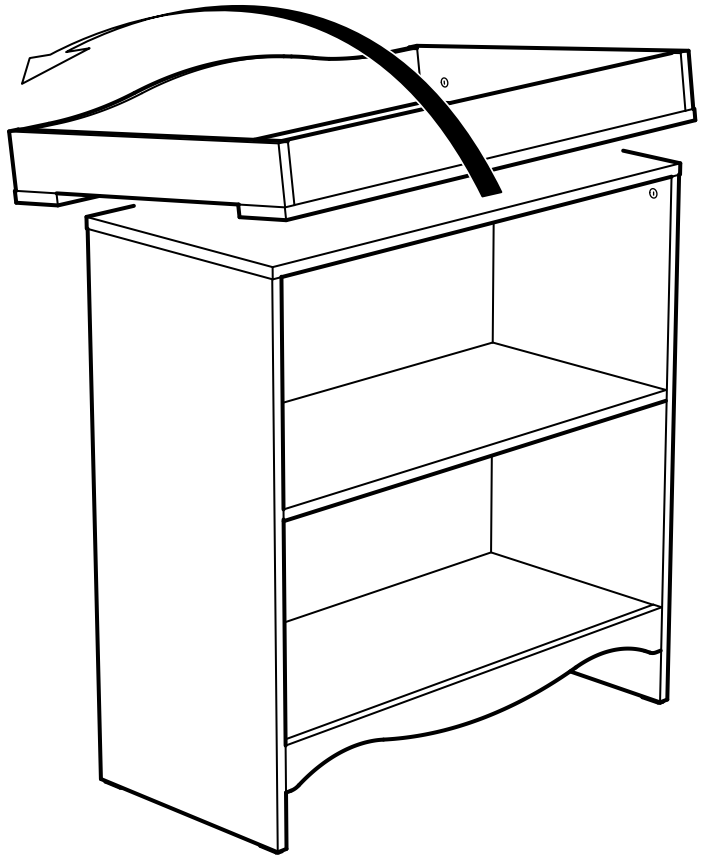

5

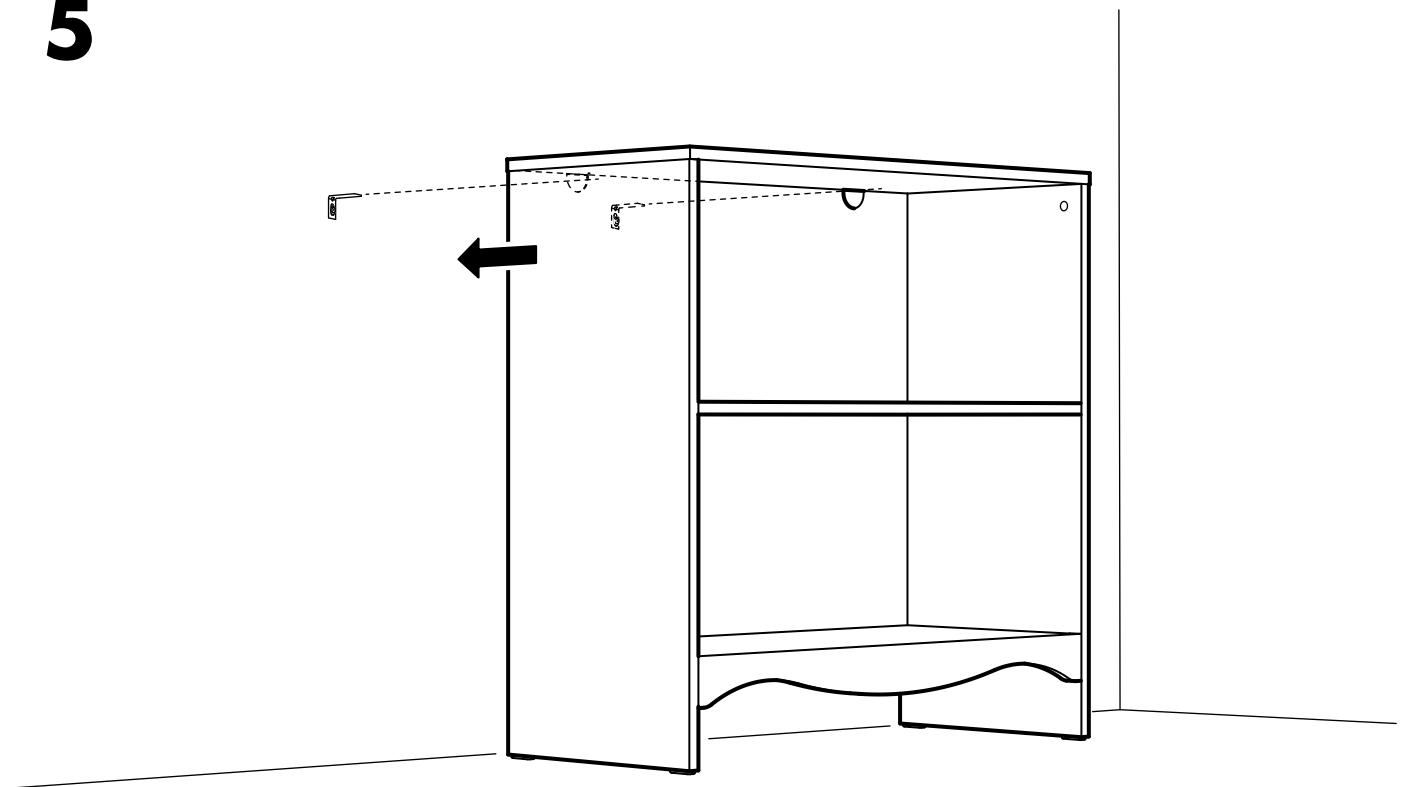

6

